

# KDF

Sports Flooring Systems & Building Materials

## SAFEPOL SANDPROOF SYSTEM PLAYGROUND FLOORING



[www.kdf.gr](http://www.kdf.gr)

**KDF LTD** ([www.kdf.gr](http://www.kdf.gr)) is one of the most dynamic and export-oriented Greek companies (currently activated in more than 70 countries in 4 continents), based in Greece (EU) and in U.A.E too, with production facilities and warehouses in both countries for acrylics and polyurethanes and **EPDM** granules.

**We are experts in sports, industrial and decorative flooring products and systems**, with huge experience in Europe with many applied projects in Spain, France, Greece as well as Malta, Romania, Bulgaria, Croatia, Serbia and Ukraine. Our presence is active in Latin America too with projects in Colombia, Peru, Chile, and Brazil, Africa, Asia, Middle East and India as well.

Our export horizon is expanding rapidly, and our goal is to stand out as a model of flexibility and competitiveness. The company, being one of the pioneer companies in the sector of sports flooring systems and building materials and giving particular attention to providing a fully upgraded range of products and services, provides certified systems according to all **EU norms and regulations** and by well-known international institutes like **WORLD ATHLETICS, I.T.F, TUV, LNE, LABOSPORT, ISASPORT, INTERTEK to name but a few.**

**KDF** goes far beyond trade, providing consultancy in marketing and technical support all the way, from the costing till the finalization of the project. Operating under the requirements of **ISO 9001/2015** (and many others like **ISO 14001/2015, ISO 50001/2018, ISO 27001/2013** and more) for production, trade and application, we make sure our products are first applied successfully at site by our own people before we launch them abroad.

Therefore, our systems have all stood the real-life test in different climates, from North Europe to Middle East till South America, and this is one of our main assets, enabling us to provide full and vertical technical support from specifying to final application plus supervision when required or even full application and costing.

**We invite you to discover a world of sports flooring expertise and solutions.**

VIEW OUR NEW SPORTS CATALOGUE



**KDF - Kataskeves Dapedon LTD**  
e : [exports@kdf.gr](mailto:exports@kdf.gr)  
w : [www.kdf.gr](http://www.kdf.gr)

19th km National Road Thessaloniki-Moudania  
57001, Neo Rysio, Thessaloniki, Greece  
t / f : +30 2310 829598

# INDICATIVE REFERENCE LIST OF PROJECTS

-12 SCHOOLS IN U.A.E, MINISTRY OF EDUCATION(THROUGH VARIOUS CONTRACTORS) - 40000m<sup>2</sup> EPDM Rubber flooring

-AL ESKAN RUNNING TRACK - BURAIDAH, K.S.A -25000m<sup>2</sup> -Running track, POLTRACK SPRAYCOAT system

-UNIVERSITY OF DAMMAM - KSA - 13000m<sup>2</sup> - Acrylic cushion floorings

-KING ABDULLAH BASE AIR DEFENSE - TAIF, KSA - 12600 m<sup>2</sup> - Running track

-KING FAHD UNIVERSITY OF PETROLEUM AND MINERALS-DHARAN, KSA-12400m<sup>2</sup>-Rubber outdoor flooring

-”KOSTAS KENTERIS” STADIUM & NATIONAL STADIUM OF MITILINI - MITILINI ISLA, GREECE - 12000m<sup>2</sup> - Running track, POLTRACK SANDWICH system

-RUNNING TRACK - K.S.A- 11000 m<sup>2</sup> - Running track, POLTRACK SANDWICH system

-GEMS SCHOOL - DUBAI, U.A.E - 10000 m<sup>2</sup> - Running track

-PASARGRAD WHOLESALE MARKET-IRAN - 10000 m<sup>2</sup> - Decorative flooring

-YAS ISLAND, ABU DHABI, U.A.E - 10000m<sup>2</sup> Bicycle track

-ANASTASIA KELESIDOU STADIUM/KONSTANTINOS KARAMANLIS - THESSALONIKI, GREECE - 10000m<sup>2</sup>

-Re-topping project, Running track, Sandwich system, Indoor & Outdoor running track

-KAFTANZOGLIO NATIONAL STADIUM OF THESSALONIKI - GREECE - 9000m<sup>2</sup>, POLTRACK SANDWICH

-ABHA STADIUM - K.S.A - 9000m<sup>2</sup> - POLTRACK SANDWICH system

-ABU DHABI STADIUM - U.A.E - 9000m<sup>2</sup> - Artificial Grass, POLITURF LEADER 55140

-ALEXANDRIA STADIUM - ALEXANDRIA, EGYPT - 8500 m<sup>2</sup> - Running track

-MINISTRY OF EDUCATION IN KUWAIT - KUWAIT - 8000m<sup>2</sup> - Polyurethane flooring, Polyflex Pu-In system

-SALAM STREET & MINA ROAD, ABU DHABI, U.A.E - 8000m<sup>2</sup> Bicycle track, Sportground-Ex system

-KING FAHAD NAVAL BASE - JUBAIL, KSA - 8000m<sup>2</sup> - Running track

-MUNICIPALITY OF VELVENTO - KOZANI, GREECE - 8000m<sup>2</sup>, Running track

-PRINCE FAISAL STADIUM IN RIYADH - K.S.A - 8000m<sup>2</sup>, Running track, POLTRACK SANDWICH system

-ABBHA, KSA - 7600m<sup>2</sup> - Running track

-MUNICIPALITY OF ZENICA - ZENICA, BOSNIA & HERZEGOVINA - 7500m<sup>2</sup>, Poltrack Spraycoat, Running track

-NATIONAL STADIUM OF TRIKALA - TRIKALA, GREECE - 7000m<sup>2</sup> - Running track POLTRACK FULL PU

-TELUK BAYAR MINI OLYMPI STADIUM - INDONESIA - 7000m<sup>2</sup> - Running track, POLTRACK SANDWICH

-ADNOC SCHOOLS - U.A.E - 7000m<sup>2</sup> - Safepol system

-MAJLIS BANDARAYA PETALING JAYA STADIUM - MALAYSIA - 7000m<sup>2</sup> POLTRACK SANDWICH

-ATLAS CENTER-BAM, IRAN - 7000 m<sup>2</sup> - Decorative flooring

-RUNNING TRACK - SUDAN - 7000 m<sup>2</sup> - Running track, POLTRACK SPRAYCOAT system

-COLOMBIA RUNNING TRACK PROJECT - 6800 m<sup>2</sup> - POLTRACK SPRAYCOAT

-MUNICIPALITY STADIUM ANDROS ISLA, GREECE - 6700m<sup>2</sup>- POLTRACK SANDWICH RETTOPING SYSTEM

-RUNNING TRACK STADIUM - CRETE, GREECE - 6500 m<sup>2</sup> - Running track, POLTRACK SANDWICH system

-PLAYGROUND PROJECT - ABU DHABI, U.A.E - 6500 m<sup>2</sup>, Safety flooring

-RUNNING TRACK STADIUM - DRAMA, GREECE - 6500 m<sup>2</sup> - Running track, POLTRACK SANDWICH system

-RUNNING TRACK PROJECT IN MUSCAT, OMAN - 6400 m<sup>2</sup> - POLTRACK SANDWICH system

-KAVALA STADIUM - KAVALA, GREECE - 6300m<sup>2</sup>- 8-lane Running track, POLTRACK SANDWICH SYSTEM

-CORNISH, JEDDAH, K.S.A - 6000m<sup>2</sup> Bicycle track Sportground-Ex system

-MUNICIPALITY STADIUM-MOLAOI, GREECE - 5800m<sup>2</sup>- POLTRACK SANDWICH SYSTEM

-MUNICIPALITY STADIUM SOFADES, GREECE - 5800m<sup>2</sup>- POLTRACK SANDWICH SYSTEM

-MUNICIPALITY STADIUM OF ALIARTOS - ALIARTOS, GREECE - 5700m<sup>2</sup>- POLTRACK SPRAYCOAT

-**ARTIFICIAL GRASS PROJECT - ATHENS, GREECE** - 5700m<sup>2</sup>, Artificial grass

-**PAPACHARALAMBIO STADIUM - NAFPAKTOS, GREECE** - 5650m<sup>2</sup> - POLTRACK SANDWICH system

-**YOKOGAWA ELECTRIC CORPORATION-DHAHRAN TECHNO VALLEY-DAMMAM, KSA** - 5500m<sup>2</sup>- Epoxy antistatic floorings

-**AMITY INTERNATIONAL SCHOOL - ABHU DHABI, U.A.E** - 5500m<sup>2</sup>, Poltrack Spraycoat, Running Track

-**MUNICIPALITY STADIUM LOUTRAKI, GREECE** - 5500m<sup>2</sup>- POLTRACK SANDWICH SYSTEM

-**SHUQAIQ WATER AND ELECTRICITY COMPANY - JIZAN, KSA** - 5400 m<sup>2</sup> - acrylic courts

-**TALEEM UPTOWN SCHOOLS - DUBAI, UAE** - 5400m<sup>2</sup>-Acrylic sports courts systems

-**SAN FERNANDO DE HENARES - SPAIN** - 5300m<sup>2</sup> - POLTRACK SANDWICH

-**SAUDI AIR FORCE - KSA** - 5250 m<sup>2</sup> - Acrylic coating elastoturf, running track

-**SHIV NADER SCHOOL - FARIDABAD, INDIA** - 5000 m<sup>2</sup> - Running track, POLTRACK SANDWICH system

-**RUNNING TRACK - K.S.A** - 5000 m<sup>2</sup> - Running track, POLTRACK SANDWICH system

-**AL HAMRA, RAS AL KHAIMAH, U.A.E** - 5000m<sup>2</sup> Bicycle track, Sportground-Ex system

-**AIRBASE IN TAIF - KSA** - 5000 m<sup>2</sup> - Running track

-**AMERICAN SCHOOL AL BARSHA - DUBAI** - 5000 m<sup>2</sup> - Running track, POLTRACK SPRAYCOAT system

-**MUNICIPALITY STADIUM AMFISSA, GREECE** - 5000m<sup>2</sup>- POLTRACK SANDWICH SYSTEM

-**NATIONAL STADIUM OF KALAMPAKA -KALAMPAKA, GREECE**-4900m<sup>2</sup>-POLTRACK SEALED SPRAYCOAT

-**MONTORNES DE VALLES - BARCELONA, SPAIN** - 4900m<sup>2</sup> - POLTRACK SPRAYCOAT

-**THAILAND STADIUM** - 4800 m<sup>2</sup> - Running track, POLTRACK SANDWICH system

-**LYCEE FRANCAIS INTERNATIONAL THEODORE MONOD** - SADIYAT, ABU DHABI, U.A.E - 4650 m<sup>2</sup> - Art. Grass POLITURF LEADER 55140

-**DEPARTMENT OF EDUCATION ASIR REGION - KHAMIS, KSA** - 4500 m<sup>2</sup> - Running track

-**SERVIA STADIUM - KOZANI, GREECE** - 4500m<sup>2</sup>, Running track

-**STADIUM OF ISLAMIC CITY OF BAWATH IN AL-AZHAR - EGYPT** - 4500m<sup>2</sup>- POLTRACK SANDWICH

-**MUNICIPALITY STADIUM OF SOFADES - GREECE** - 4500m<sup>2</sup>- POLTRACK SANDWICH SYSTEM

-**"POSIDONIO" NATIONAL ATHLETIC CENTER - THESSALONIKI, GREECE** - 4300m<sup>2</sup>- Acrylic certified flooring

-**MUNICIPALITY STADIUM OF MESSINI - GREECE** - 4300m<sup>2</sup>- Running track, POLTRACK SANDWICH SYSTEM

-**COMMUNITY COLLEGE - KHAMIS, KSA** - 4200 m<sup>2</sup> - Running track

-**FAYOUM INIVERSITY - EGYPT** - 4200m<sup>2</sup> - Polyurethane sports flooring, POLYFLEX PU System

-**POLIDEPORTIVO UNIVERSIDAD ALCALA DE HENARES-MADRID,SPAIN**-4000m<sup>2</sup>-POLTRACK SPRAYCOAT

-**MULTIPLE RUNNING TRACKS - ALGERIA** - 40000 m<sup>2</sup> - Running track, POLTRACK SPRAYCOAT system

-**SPORTS CLUB CENTER GLIFADA - ATHENS, GREECE** - 4000m<sup>2</sup>- Poltrack Spraycoat, Running Track

-**EMIRATES INTERNATIONAL SCHOOL - DUBAI, U.A.E** - 4000m<sup>2</sup> - Safepol System, Playground flooring

-**RUNNING TRACK PROJECT IN QATAR** - 4000m<sup>2</sup>, Poltrack Spraycoat system

-**RUNNING TRACK PROJECT IN SAMOS - GREECE** - 4000m<sup>2</sup>, Poltrack Spraycoat system

-**HH KHALID BIN BANDAR - RIYADH, KSA** - 3800 m<sup>2</sup> - Volleyball/basketball rubber courts

-**SPORTS FLOORING COMPLEX - ISRAEL** - 3700 m<sup>2</sup>, Acrylic sports flooring, SPORTFLOOR-EX system

-**MUNICIPALITY STADIUM OF AGIA PARASKEVI, GREECE** - 3700m<sup>2</sup>- POLTRACK SANDWICH SYSTEM

-**RUNNING TRACK- UKRAINE** - 3600m<sup>2</sup> - RunningTrack, Poltrack Spraycoat system

-**ANATOLIA GOLLEGE - THESSALONIKI, GREECE** - 3600m<sup>2</sup>, Running track

-**AIMARJAN ASLAND – PARTIAL** - 3600m<sup>2</sup>- Poltrack Sandwich, Running Track

-**RUNNING TRACK - ISRAEL** - 3500m<sup>2</sup> - Running track, POLTRACK SANDWICH system

-**RUNNING TRACK PROJECT - EGYPT** - 3500m<sup>2</sup> - Running track, POLTRACK SPRAYCOAT system

-**BICYCLE TRACK PROJECT - GREECE** - 3500m<sup>2</sup>- Acrylic sports flooring, SPORTGROUND-EX system

-MUNICIPALITY OF ALIMOS - ATHENS, GREECE - 3500m<sup>2</sup>- Acrylic sports flooring, SPORTFLOOR FAST

-MUNICIPALITY STADIUM OF HOLARGOS, ATHENS- GREECE - 3500m<sup>2</sup>- POLTRACK SANDWICH SYSTEM

-MATRIX SPORTING CLUB - EGYPT - 3400m<sup>2</sup> - Polyurethane outdoor flooring, Polyflex PU-EX System

-RUNNING TRACK PROJECT - EGYPT - 3400m<sup>2</sup> - Running track, POLTRACK SPRAYCOAT system

-SPORTS CLUB CENTER KISSAMOS - CRETE, GREECE - 3200m<sup>2</sup>- Poltrack Sandwich, Running Track

-AL LUSAIL SPORTS CLUB - DOHA, QATAR - 3200m<sup>2</sup> - Jogging track

-SPORTS CLUB CENTER - SERBIA, GREECE - 3200m<sup>2</sup> - Poltrack Sandwich, Running Track

-STADIUM CENTER - UKRAINE - 3200m<sup>2</sup> - RunningTrack, Poltrack Spraycoat system

-KING KHALID UNIVERSITY - ABHA, KSA - 3100 m<sup>2</sup> - Running track

-ISLAMIC WORLD GARDEN - SHARJA, U.A.E - 3000m<sup>2</sup>- Safety flooring, SAFEPOL MULTICOLOR system

-AL FAIOUM UNIVERSITY - FAIOUM, EGYPT - 3000m<sup>2</sup>- Polyurethane indoor flooring, Polyflex PU-IN system

-RUNNING TRACK PROJECT - VELVEDOS MUNICIPALITY, GREECE - 3000m<sup>2</sup>- POLTRACK SANDWICH

-WADY DEGLA OCTOBER CLUB - CAIRO, EGYPT - 3000m<sup>2</sup>- Acrylic sports courts

-SPORTS CLUB CENTER "PAPAGOU"- ATHENS, GREECE - 3000m<sup>2</sup>- Poltrack Sandwich, Running Track

-PANORAMA SPORTS COMPLEX - THESSALONIKI, GREECE - 3000m<sup>2</sup>, Running track

-PLAYGROUND FLOORING PROJECT IN NORTHERN GREECE - KILKIS, GREECE - 3000m<sup>2</sup>- SAFEPOL

-BENHA SPORTS CITY - EGYPT - 3000m<sup>2</sup>- Acrylic sports courts

-SPORTS COMPLEX IN UKRAINE - 3000m<sup>2</sup> - Safety flooring, SAFEPOL MULTICOLOR system

-JOGGING TRACK AT WATERFONT - K.S.A - 3000m<sup>2</sup> - POLTRACK JOGGING TRACK

-PLAYGROUND FLOORING IN SHARJA - U.A.E - 3000m<sup>2</sup> - Playground flooring, SAFEPOL MULTICOLOR

-SPORTS FLOORING PROJECT IN YEMEN - 3000m<sup>2</sup>- Acrylic sports courts, SPORTFLOOR-EX

-SPORTS SCHOOL PROJECT - ARTA, GREECE - 3000m<sup>2</sup>- Acrylic sports courts, POLYFLEX AEL-EX

-ALIMOS STADIUM - ALIMOS, GREECE - 2850m<sup>2</sup>- Running track, POLTRACK SANDWICH

-INDIAN ARMY - SAGAR, INDIA - 2800m<sup>2</sup>- Acrylic sports courts

-ALL SAINTS SCHOOL - MUMBAI, INDIA - 2700 m<sup>2</sup> - PU outdoor sports flooring and running track

-INDIAN INSTITUTE OF SCIENCE EDUCATION AND RESEARCH-BHOPAL,INDIA-2700m<sup>2</sup>-Acrylic sports courts

-RESORT IN RED SEA - EGYPT - 2700m<sup>2</sup>- Acrylic sports courts, FLEXFLOOR-EX system

-OUR OWN GOLF SCHOOL - 2700m<sup>2</sup>- Poltrack Spraycoat, RunningTrack

-STADIUM STUDENSKA, SPORTS COMPLEX - BARNNA, BOULGARIA - 2700m<sup>2</sup>- SPORTFLOOR-EX system

-OUTDOOR SPORTS VENUE - VARNNA, BULGARIA - 2700 m<sup>2</sup> - Acrylic, ITF classified, 8 layers system

-RAKS PALLIKOODAM SCHOOL - INDIA - 2600m<sup>2</sup> - Acrylic sports courts, FLEXFLOOR-EX system

-DPS GUNTUR SITE, NEW DELHI INDIA - 2600m<sup>2</sup>- Acrylic sports courts, SPORTFLOOR-EX system

-HIGH SCHOOL COMPLEX - ATTIKA DISTRICT - 2500m<sup>2</sup>- Acrylic sports courts, SPORTFLOOR FAST system

-KURNISH AL KHOBAR - K.S.A - 2500m<sup>2</sup>- Rubber flooring, COLORFLEX system

-AL RAYAN, QATAR - 2500 m<sup>2</sup> - Running track, POLTRACK SANDWICH system

-MUNICIPALITY PARK OF TRIKALA - GREECE - 2500 m<sup>2</sup> - Running track, POLTRACK FULL-PU

-ALHOSN SPORTS COMPLEX - 2400 m<sup>2</sup> - Running track, POLTRACK SANDWICH system

-PROJECT BELICA - CROATIA - 2300 m<sup>2</sup> - Running track, POLTRACK SPRAYCOAT system

-MUNICIPAL SPORTS CENTER PAVLOU MELA - THESSALONIKI, GREECE - 2300 m<sup>2</sup> - SPORTFLOOR-EX

-MUNICIPALITY STADIUM OF DOXATO - GREECE - 2300m<sup>2</sup>- POLTRACK SANDWICH SYSTEM

-TORRES DE COTILLAS - SPAIN - 2300m<sup>2</sup>- POLTRACK SPRAYCOAT

-WADY DEGLA EL NAKHIL CLUB - CAIRO, EGYPT - 2260m<sup>2</sup>- Acrylic sports courts, POLYFLEX AEL-EX

-OUTDOOR SPORTS FLOORING PROJECT - INDIA - 2250 m<sup>2</sup>- Acrylic sports courts, SPORTFLOOR-EX

-SPORTS FLOORING PROJECT IN BULGARIA - 2200 m<sup>2</sup>- Acrylic sports courts, SPORTFLOOR-EX system

**-LULU SCHOOL - ABU DHABI, U.A.E - 2200 m<sup>2</sup> - SAFEPOL MULTICOLOR**  
**-TEACHERS COLLEGE - ABHA, KSA - 2050 m<sup>2</sup> - Running track**  
**-MUSAB BIN OMAIR BOYS SCHOOL - BIN OMRAN, QATAR - 2050 m<sup>2</sup> - PU outdoor sport flooring**  
**-BURAIRAT SCHOOL - RAK, UAE - 2000 m<sup>2</sup> - Running track**  
**-SPORTS CENTRE OF GERAKAS - ATHENS, GREECE - 2000m<sup>2</sup> - Acrylic sports courts, SPORTFLOOR-EX**  
**-HADAYEK ALAHRAM CLUB - GIZA, EGYPT - 2000m<sup>2</sup>-PU outdoor sports flooring, POLYFLEX PU-EX WET- POUR**  
**-JP, ADA CIGANLIJA - BELGRADE, SERBIA - 2000m<sup>2</sup> - SPORTFLOOR-EX**  
**-YASMINA SCHOOL - ABUDHABI, U.A.E - 2000m<sup>2</sup> - Playground flooring, SAFEPOL MULTICOLOR**  
**-SCHOOL COMPLEX IN NAXOS ISLAND - GREECE - 2000m<sup>2</sup> - Acrylic sports courts, SPORTFLOOR-FAST**  
**-MUNICIPALITY STADIUM OF MALIA, CRETE - GREECE - 2000m<sup>2</sup>- POLTRACK SPRAYCOAT SYSTEM**  
**-AL SAILIYA BOYS SCHOOL - AL SAILIYA, QATAR - 2000 m<sup>2</sup> - Polyurethane, outdoor sport flooring**  
**-KING KHALID UNIVERSITY - ABHA, KSA - 2000 m<sup>2</sup> - Volleyball/basketball rubber courts**  
**-HH KHALID BIN BANDAR - RIYADH, KSA - 2000 m<sup>2</sup> - Volleyball/basketball rubber courts**  
**-MUNICIPALITY STADIUM OF DRAMA - GREECE - 2000m<sup>2</sup>- POLTRACK SANDWICH SYSTEM**  
**-RAWDA RASHEED PRIMARY SCHOOL FOR BOYS - 2000 m<sup>2</sup> - Outdoor sports flooring**  
**-DEIRA INTERNATIONAL SCHOOL - DUBAI, U.A.E - 2000 m<sup>2</sup> - POLYFLEX PU-IN**  
**-DAMIETTA GOVERNMENT - EGYPT - 2000m<sup>2</sup> - Running track, Poltrack Spraycoat Sealed System**  
**-MUNICIPAL STADIUM OF GIANNITSA-GIANNITSA,GREECE-2000m<sup>2</sup> -Running track POLTRACK SANDWICH**  
**-AL WAKAIR BOYS SCHOOL - AL WAKRAH, QATAR - 1950 m<sup>2</sup> - Polyurethane, outdoor sport flooring**  
**-THE LAKE DISTRICT - PUNE, INDIA - 1950m<sup>2</sup>- Acrylic sports courts**  
**-PRESIDENTIAL GUARD COMMANDM MAHAWI - ABU DHABI, UAE - 1900m<sup>2</sup> - Football court**  
**-GEMS CAMBRIDGE INTERNATIONAL SCHOOL - HOSHIYARPUR, INDIA - 1900m<sup>2</sup> - FLEXFLOOR-EX**  
**-MUNICIPALITY STADIUM KARPENISI, GREECE - 1900m<sup>2</sup>- POLTRACK SANDWICH SYSTEM**  
**-UNITED (SABIC) SPORTS CLUB - 1900 m<sup>2</sup> - Rubber flooring**  
**-OUTDOOR SPORTS FLOORING PROJECT - PAKISTAN - 1900 m<sup>2</sup> - WET-POUR POLYFLEX AEL-EX**  
**-SHOOLS MINISTRY OF EDUCATION - KHAMIS, KSA - 1800 m<sup>2</sup> - Rubber flooring**  
**-AL MAJAD AMPHITHEATER - SHARJA, UAE - 1800m<sup>2</sup> - Certified Jogging track**  
**-QASSIM UNIVERSITY - KSA - 1800m<sup>2</sup> - Polyurethane sports flooring**  
**-MODERN ENGLISH SCHOOL - EGYPT - 1785m<sup>2</sup> - Running track, POLTRACK SPRAYCOAT**  
**-AL QADSIYA MODEL INDEPENDENT SCHOOL - ALWAAB, QATAR - 1770 m<sup>2</sup> - PU outdoor sport flooring**  
**-IKNS SCHOOL - BAHRAIN - 1700 m<sup>2</sup> - Playground flooring, SAFEPOL MULTICOLOR system**  
**-AL WAHDA SPORT ACADEMY CLUB - ABU DHABI, UAE - 1700 m<sup>2</sup> - Acrylic sports system**  
**-MUNICIPALITY STADIUM OF AGIA VARVARA - GREECE - 1700m<sup>2</sup>- POLTRACK SPRAYCOAT SYSTEM**  
**-MULTIPURPOSE ACRYLIC COURTS - BAHRAIN - 1700 m<sup>2</sup> - SPORTFLOOR-EX system**  
**-ALSARH SCHOOLS OF CIVIL - RIYADH, KSA - 1650m<sup>2</sup> - PU glue/Socccer field**  
**-PLAYGROUND FLOORING PROJECT IN QATAR - 1650m<sup>2</sup> - SAFEPOL MULTICOLOR system**  
**-ESTADIO PROVINCIAL DE SANDIA - PUNO, PERU - 1650m<sup>2</sup> - POLTRACK SANDWICH**  
**-GD GOENKA PUBLIC SCHOLL - PURNIA, INDIA - 1630m<sup>2</sup>- Acrylic sport1600 m<sup>2</sup> - s courts**  
**-CIVIL DEFENCE TRAINING CENTER, EASTERN PROVINCE - K.S.A - 1600 m<sup>2</sup> - POLTRACK SPRAYCOAT**  
**-SPA RESORT DERENIVSKUPIA KI - UZHGOROD, UKRAINE - 1600 m<sup>2</sup> - Flexfloor-ex system, volleyball court**  
**-CIVIL DEFENCE TRAINING CENTER, EASTERN PROVINCE - K.S.A - 1600 m<sup>2</sup> - POLYFLEX PU-IN**  
**-IISER, INDIAN INSTITUTE OF SCIENCE EDUCATION AND RESEARCH - BHOPAL, INDIA - 1600m<sup>2</sup> - Acrylic sports courts, FLEXFLOOR-EX system**  
**-EFKARPIA MUNICIPALITY - THESSALONIKI, GREECE - 1600m<sup>2</sup> - Acrylic sports courts,SPORTFLOOR-EX**

-GRACANICA SPORTS CENTRE - KOSOVO - 1600m<sup>2</sup> - Running Track, POLTRACK PRAYCOAT system

-RUNNING TRACK PROJECT IN BOSNIA & HERZEGOVINA - 1585<sup>2</sup> - POLTRACK PRAYCOAT

-THE MILITARY HOSPITAL - RIYADH, KSA - 1560 m<sup>2</sup> - Volleyball/basketball rubber courts-PU sports flooring

-STADIUM IN BAJRAM CURRI - TROPOJA, ALBANIA - 1550 m<sup>2</sup> - SPRAYCOAT system

-SCHOOL SPORTS COMPLEX IN POLIGIROS - GREECE - 1550m<sup>2</sup>- Acrylic flooring, SPORTFLOOR FAST

-AL FORSHAN SPORTS CENTRE - ABU DHABI, U.A.E - 1500m<sup>2</sup> - Smartfloor system, Acrylic flooring

-INDUSTRIAL FLOORING - BULGARIA - 1500m<sup>2</sup> - Epoxy flooring, Polepox Coat 814 system

-SCHOOL IN AL WAKRA CITY - DOHA, QATAR - 1500 m<sup>2</sup> - Playground flooring

-REAL SCHOOL SHAH ALAM - MALAYSIA - 1500 m<sup>2</sup> - POLTRACK SPRAYCOAT

-IRAQ ARMY CAMP - IRAQ - 1500m<sup>2</sup> - Acrylic flooring in 2,2mm

-BICYCLE TRACK PROJECT - LARISA-TRIKALA, GREECE - 1500 m<sup>2</sup> - SPORTGROUND-EX

-PROJECT GREEN LAND - DUBAI, UAE - 1500 m<sup>2</sup> - Jogging track

-UP TOWN SCHOOL - 1500m<sup>2</sup>- Poltrack Spraycoat, RunningTrack

-INDIAN AIR FORCE - ALLAHABAD, INDIA - 1450m<sup>2</sup> - Acrylic sports courts

-OUTDOOR SPORTS COURT COMPLEX - INDIA -1400m<sup>2</sup>- PU flooring, WET-POUR POLYFLEX PU-EX

-SPORTS FLOORING PROJECT IN KOSOVO - STREET BALL - 1400m<sup>2</sup>- SPORTFLOOR-EX

-DUBAI MODERN HIGH SCHOOL - DUBAI, UAE - 1375 m<sup>2</sup> - Acrylic sports courts

-PROJECT ECOGREEN - DUBAI, UAE - 1350 m<sup>2</sup> - Jogging track

-SAVA BASELINE ACADEMY - MALTA - 1350m<sup>2</sup> - SMARTFLOOR-EX

-SPORTS FLOORING PROJECT - BANSKO, BULGARIA - 1350 m<sup>2</sup> - Acrylic sports courts

-”10” NATIONAL TV STATION - KOSOVO - 1300 m<sup>2</sup> - Outdoor, acrylic flooring, WET POUR POYFLEX AEL-EX

-POLICE COMPLEX BARRACKS NIZWA - OMAN- 1300 m<sup>2</sup> - Colorflex, PU sport flooring

-POLICE COMPLEX BARRACKS AL AJAIZ - OMAN - 1300 m<sup>2</sup> - Colorflex, PU sport flooring

-POLICE COMPLEX BARRACKS KATMATMILAH SITE - OMAN- 1300 m<sup>2</sup> - Colorflex, PU sport flooring

-POLICE COMPLEX BARRACKS SUWAIQ - OMAN - 1300 m<sup>2</sup> - Colorflex, PU sport flooring

-POLICE COMPLEX BARRACKS AL KAMIL - OMAN - 1300 m<sup>2</sup> - Colorflex, PU sport flooring

-PLAYGROUND FLOORING - BAHRAIN - 1300m<sup>2</sup> - Safepol system

-POLICE COMPLEX BARRACKS SHINAS - OMAN - 1300 m<sup>2</sup> - Colorflex, PU sport flooring

-POLICE COMPLEX BARRACKS BHALA - OMAN - 1300 m<sup>2</sup> - Colorflex, PU sport flooring

-POLICE COMPLEX BARRACKS MUDHAIBI - OMAN - 1300 m<sup>2</sup> - Colorflex, PU sport flooring

-POLICE COMPLEX BARRACKS THUMRAIT - OMAN - 1300 m<sup>2</sup> - Colorflex, PU sport flooring

=BASKETBALL COURTS PROJECT - NEAPOLI, THESSALONIKI, GREECE - 1300m<sup>2</sup> - SPORTFLOOR-EX

-POLICE COMPLEX BARRACKS AL KHOUDH - OMAN - 1300 m<sup>2</sup> - Colorflex, PU sport flooring

-POLICE COMPLEX BARRACKS MAHDAH - OMAN - 1300 m<sup>2</sup> - Colorflex, PU sport flooring

-POLICE COMPLEX BARRACKS BID BID - OMAN - 1300 m<sup>2</sup> - Colorflex, PU sport flooring

-POLICE COMPLEX BARRACKS AL KHABOORA - OMAN - 1300 m<sup>2</sup> - Colorflex, PU sport flooring

-POLICE COMPLEX BARRACKS DHANK - OMAN - 1300 m<sup>2</sup> - Colorflex, PU sport flooring

-POLICE COMPLEX BARRACKS HAFEET - OMAN - 1300 m<sup>2</sup> - Colorflex, PU sport flooring

-POLICE COMPLEX BARRACKS AUQAD - OMAN - 1300 m<sup>2</sup> - Colorflex, PU sport flooring

-POLICE COMPLEX BARRACKS SUMAIL - OMAN - 1300 m<sup>2</sup> - Colorflex, PU sport flooring

-MATRIX SPORTING CLUB - EGYPT - 1300 m<sup>2</sup> - Acrylic flooring, Flexfloor System

-OUTDOOR SPORTS VENUE - KOSOVO - 1300 m<sup>2</sup> - POLTRACK SPRAYCOAT System

-MUNICIPALITY SPORTS CENTRE SYKIES, THESSALONIKI - GREECE - 1300m<sup>2</sup>- POLTRACK SANDWICH

-SPORTS HALL IBRI - MUSCAT, OMAN - 1300 m<sup>2</sup> - Indoor sports flooring POLYFLEX PU-IN

**-ALHALAFI BREAK - RIYADH, KSA - 1276 m<sup>2</sup> - Rubber flooring**  
**-DELHI PUBLIC SCHOOL - ETAWAH, INDIA - 1250m<sup>2</sup>- Acrylic sports courts, FLEXFLOOR-EX system**  
**-GI-DHOFAR BEACH RESORT & SPA - OMAN - 1225 m<sup>2</sup> - Colorflex, PU sport flooring**  
**-RLS BASIC EDUCATION SCHOOL SOHAR - OMAN - 1225 m<sup>2</sup> - Colorflex, PU sport flooring**  
**-MIXED BASIC EDUCATION SCHOOL AL QABIL - OMAN - 1225 m<sup>2</sup> - Colorflex, PU sport flooring**  
**-BOYS BASIC EDUCATION SCHOOL BARKHA - OMAN - 1225 m<sup>2</sup> - Colorflex, PU sport flooring**  
**-GIRLS BASIC EDUCATION SCHOOL MUDHAIBI - OMAN - 1225 m<sup>2</sup> - Colorflex, PU sport flooring**  
**-MIXED BASIC EDUCATION SCHOOL AL AMERAT - OMAN - 1225 m<sup>2</sup> - Colorflex, PU sport flooring**  
**-UMSALAMA GIRLS SCHOOL - AL RAYYAN, QATAR - 1200 m<sup>2</sup> - Polyurethane, outdoor sport flooring**  
**-SHERATON PARK - DOHA, QATAR - 1200 m<sup>2</sup> - Playground flooring**  
**-RAWDA BIN JASSIM SCHOOL - AL AZIZIYAH, QATAR - 1200 m<sup>2</sup> - Polyurethane, outdoor sport flooring**  
**-GEMS WESTMINISTER SCHOOL - DUBAI, U.A.E - 1200 m<sup>2</sup> - Acrylic sports courts**  
**-SILVER SPORTS CLUB - INDIA - 1200m<sup>2</sup>- Acrylic sports courts**  
**-OUR OWN SCHOOL - SHARJA, U.A.E - 1200m<sup>2</sup> - Acrylic sports courts**  
**-SHARJAH FOOTBALL CLUB - SHARJAH, UAE - 1200 m<sup>2</sup> - Polyurethane basketball courts**  
**-SHERATON PARK - DOHA, QATAR - 1200 m<sup>2</sup> - Playground flooring**  
**-CHILE RUNNING TRACK PROJECT - 1200 m<sup>2</sup> - Running track, POLTRACK SPRAYCOAT system**  
**-EGYPT RUNING TRACK PROJECT - 1200m<sup>2</sup>, Running Track, POLTRACK SPRAYCOAT system**  
**-EGYPT RUNING TRACK PROJECT - 1200m<sup>2</sup>, Running Track, POLTRACK SANDWICH system**  
**-ALIGARH MUSLIM UNIVERSITY - ALIGARH, INDIA - 1200 m<sup>2</sup> - Acrylic sports courts, FLEXFLOOR-EX system**  
**-SUMMER RESORT, KIDS Paly Area - CHALKIDIKI, GREECE - 1200 m<sup>2</sup> - Playground flooring, SAFEPOL**  
**-SPORTS FLOOR PROJECT IN PAKISTAN - 1200 m<sup>2</sup> - Acrylic sports courts, POLYFLEX AEL-EX**  
**-SCHOOL COMPLEX - ZAKINTHOS, GREECE - 1200 m<sup>2</sup> - Acrylic sports courts, SPORTFLOOR FAST**  
**-SYMBIOSIS COLLEGE - INDIA - 1180m<sup>2</sup>- Acrylic sports courts**  
**-SPORTS PROJECT IN EGYPT - 1170m<sup>2</sup>- Acrylic sports courts, POLYFLEX AEL-EX**  
**-PROFESSOR ABDULAZIZ ANQARI - RIYADH, KSA -1150m<sup>2</sup> - PU glue/Socccer field**  
**-ACRYLIC, OUTDOOR SPORTS FLOORING PROJECT - KARACHI, PAKISTAN -1150m<sup>2</sup> - FLEXFLOOR-EX**  
**-AL SAQID ISLAMIC ENGLISH SHCOLL-DUBAI,UAE-1100m<sup>2</sup>- Acrylic flooring, WET-POUR POLYFLEX AEL-EX**  
**-REAL SCHOOL HULU LANGAT - MALAYSIA - 1100m<sup>2</sup> - POLTRACK SPRAYCOAT**  
**-MAADI BRITISH SCHOOL- EGYPT - 1100m<sup>2</sup>, Multipurpose court, COLORFLEX system**  
**-OUTDOOR SPORTS PROJECT IN FOCSANI REGION - ROMANIA - 1100m<sup>2</sup> - POLTRACK SPRAYCOAT**  
**-CENTRAL SQUARE OF MUNICIPALITY OF THERMI - THESSALONIKI, GREECE - 1100m<sup>2</sup>, Decorative flooring MARMOR FLOOR system**  
**-KORYDALLOS DISTRICT - ATHEN**  
**-CINEGUILLA - PERU - 1100m<sup>2</sup> - POLYFLEX PU-EX**  
**-FIRST POINT SCHOOLS - DUBAI, UAE1100m<sup>2</sup> - Acrylic sports courts**  
**-OUTDDOR SPORTS FLOORING PROJECT-ARTA, GREECE-1100m<sup>2</sup>-POLYFLEX AEL-EX & SPORTFLOOR**  
**-TUMBES - PERU - 1100m<sup>2</sup> - POLYFLEX PU-IN**  
**-DUBAI AMERICAN ACADEMY - DUBAI, UAE - 1080 m<sup>2</sup> - Acrylic sports court**  
**-PRELUDE PUBLIC SCHOOL - AGRA, INDIA - 1070m<sup>2</sup>- Acrylic sports courts**  
**-INDOOR SPORTS FLOORING PROJECT - JORDAN - 1055m<sup>2</sup> - Polyurethane POLYFLEX PU-IN**  
**-ALMGBAL BREAK - RIYADH, KSA - 1050 m<sup>2</sup> - Rubber playgroundS, GREECE - 1100m<sup>2</sup> - FLEXFLOOR-EX**  
**-BANIYAS CLUB AND AL AIN ENGLISH SPEAKING SCHOOL - ABU DHABI, UAE - 1000m<sup>2</sup> - Acrylic flooring**  
**-WADY DEGLA LOTUS PROJECT - CAIRO, EGYPT - 1000 m<sup>2</sup> - Acrylic flooring, Wet-Pour Polyflex AEL-EX**

-GRAVA SCHOOL COMPLEX - ATHENS, GREECE - 1000 m<sup>2</sup> - POLTRACK SANDWICH RETTOPING

-INDIAN AIR FORCE - VARANASI, INDIA - 1000m<sup>2</sup> - Acrylic sports courts

-GARDENIA RESIDENTS - DUBAI, U.A.E - 1000 m<sup>2</sup> - SAFEPOL MULTICOLOR system

-JINDAL UNIVERSITY - SONIPAT, HARYANA, INDIA - 1000m<sup>2</sup> - PU flooring WET-POUR POLYFLEX PU-EX

-MINISTRY OF EDUCATION - DAMMAM, KSA - 1000 m<sup>2</sup> - PU indoor multipurpose sports flooring

-SHEIKH OBEID MAKTHOUM PALACE - 1000m<sup>2</sup> - Outdoor polyurethane flooring

-INDIAN AIR FORCE - AGRA, INDIA - 1000m<sup>2</sup> - Acrylic sports courts

-INDONESIA - 1000 m<sup>2</sup> - PU indoor multipurpose sports flooring

-INDIAN AIR FORCE - LUCKNOW, INDIA - 1000m<sup>2</sup> - Acrylic sports courts

-MULTIPURPOSE POLYURTEHANE INDOOR COURTS - F.Y.R.O.M - 1000m<sup>2</sup> - Polyflex PU-In system

-SODIC PROJECT - EGYPT - 1000m<sup>2</sup>, Multipurpose court, COLORFLEX system

-MUNICIPALITY STADIUM OF LARISA "ALKAZAR"- GREECE -1000m<sup>2</sup>-POLTRACK SANDWICH RETTOPING

-INDIAN AIR FORCE - VARANASI, INDIA - 1000m<sup>2</sup> - Acrylic sports courts

-INTERNATIONAL SCHOOL OF CREATIVE SCHIENCE - SHARJAH, U.A.E - 1000m<sup>2</sup> - Safepol System

-INDIAN AIR FORCE - BIHTA, INDIA - 1000m<sup>2</sup> - Acrylic sports courts

-INDIAN AIR FORCE - DARBHANGA, INDIA - 1000m<sup>2</sup> - Acrylic sports courts

-AL AIN INDIAN SCHOOL - AL AIN, UAE - 1000m<sup>2</sup> - Football court

-GREEK AIR FORCE ACADEMY - TATOI, ATHENS, GREECE - 1000m<sup>2</sup> - PU flooring, POLYFLEX PU-IN

-DUBAI SCHOLRAS PRIVATE SCHOOL - DUBAI, U.A.E - 1000m<sup>2</sup> - Acrylic flooring in 2,2mm

-OBOOR SPORTS CLUB - EGYPT - 1000m<sup>2</sup> - Acrylic flooring

-CAMANA - PERU - 1000m<sup>2</sup> - POLYFLEX PU-IN

-INDOOR SPORTS PROJECT IN OMAN - MINISTRY OF EDUCATION - 1000m<sup>2</sup> - PU sports flooring

-VIT AP CAMPUS, AMARAVANTHI, VIJAYAWADA, ANDHRA PRADESH - INDIA - 985m<sup>2</sup> POLYFLEX PU-IN

-MONARCH INTERNATIONAL SCHOOL - 950m<sup>2</sup>- Acrylic sports courts, FLEXFLOOR-EX system

-FOOTBALL COURT - LIMASSOL, CYPRUS - 950m<sup>2</sup> - Artificial grass, POLITURF IMPERIAL 50140

-MULTISPORT FIELD GADIME - KOSOVO - 950m<sup>2</sup> - POLTRACK SPRAYCOAT

-COMMUNITY COLLEGE - KHAMIS, KSA - 940 m<sup>2</sup> - Polyurethane indoor multipurpose sports flooring

-GEMS METROPOLE SCHOOL - DUBAI, U.A.E - 900 m<sup>2</sup> - Playground flooring

-PLAYGROUND FLOORING IN KHARKIV-2 - UKRAINE - 900m<sup>2</sup> - SAFEPOL MULTICOLOR system

-MINISTRY OF EDUCATION - ABHA, KSA - 900 m<sup>2</sup> - Polyurethane indoor multipurpose sports flooring

-BAB AL SHAMS SPA HOTEL - DUBAI, UAE - 900m<sup>2</sup> - Football court

-STREET BALL COURTS - BOSNIA 7 HERZEGOVINA - 880m<sup>2</sup> - POLTRACK SPRAYCOAT system

-CAIRO FESTIVAL CITY ORIANA PROJECT - EGYPT - 855m<sup>2</sup> - Playground flooring, SAFEPOL MULTICOLOR

-INDIAN NAVY - KOCHI, INDIA - 850m<sup>2</sup> - Acrylic sports courts, FLEXFLOOR-EX system

-PARCONA - PERU - 850m<sup>2</sup> - POLYFLEX PU-EX

-SCHOOL SPORTS COMPLEX - K.S.A - 850m<sup>2</sup> - POLYFLEX AEL-EX

-CHICAUMA PROJECT - CHILE - 850m<sup>2</sup> - SAFEPOL MULTICOLOR

-GALGOTIAS UNIVERSITY - NOIDA, INDIA - 830m<sup>2</sup>- Acrylic sports courts, FLEXFLOOR-EX system

-KING KHALID UNIVERSITY - ABHA, KSA - 820 m<sup>2</sup> - Polyurethane indoor multipurpose sports flooring

-SCHOOL COMPLEX - KOSOVO - 820 m<sup>2</sup> - SPORTFLOOR-EX, ITF classified – class 4

-YLL MORINA SCHOOL - GJAKOVA, KOSOVO - 810m<sup>2</sup>- Outdoor sports project, POLTRACK SPRAYCOAT

-GYMNASIUM IN OBERHOFFEN - ALSACE, FRANCE - 800m<sup>2</sup>- POLYFLEX PU-IN

-SPORTS CENTER ANTIRIO - GREECE - 800m<sup>2</sup> - Running track POLTRACK SPRAYCOAT

-JINDAL UNIVERSITY - SONIPAT, HARYANA, INDIA - 800m<sup>2</sup> - POLTRACK JOGGING TRACK

-**ARTIFICIAL GRASS - STATOVCHA, BULGARIA** - 800m<sup>2</sup> - Artificial grass, POLITURF ROYAL 5588

-**SCHOOL IN AL WAKRA CITY - DOHA, QATAR** - 800m<sup>2</sup> - Polyurethane sports flooring

-**SULTAN MANOR - RIYADH, KSA** - 800m<sup>2</sup> - Polyurethane multipurpose sports flooring

-**MINISTRY OF EDUCATION - AL KHARIZ, KSA** - 800m<sup>2</sup> - PU indoor multipurpose sports flooring

-**GEMS AMERICAN ACADEMY - ABU DHABI - U.A.E** - 800m<sup>2</sup> - Running track POLTRACK SANDWICH

-**INDOOR SPORTS COURT - MALAYSIA** - 800m<sup>2</sup> - PU indoor sports flooring

-**KID'S PLAY AREA IN MALL - MOROCCO** - 800m<sup>2</sup> - PU indoor sports flooring, POLYFLEX PU-IN system

-**MARASSI R1 PROJECT - EGYPT** - 800m<sup>2</sup> - Playground flooring, SAFEPOL MULTICOLOR system

-**SPORTS CENTER GLIFADA, ATHENS - GREECE** - 800m<sup>2</sup> - Running track POLTRACK SANDWICH

-**SPORTS CENTER VRILISIA, ATHENS - GREECE** - 800m<sup>2</sup> - Running track POLTRACK SANDWICH

-**DUBAI ENGLISH SPEAKING COLLEGE - DUBAI, UAE** - 783m<sup>2</sup> - Acrylic flooring, SPORTFLOOR-EX

-**SINGAPORE AIRLINES - SINGAPORE** - 735m<sup>2</sup> - PU indoor sports flooring

-**HAYATABAD PESHAWAR - INDIA** - 750m<sup>2</sup> - Polyurethane sports flooring, POLYFLEX PU-IN

-**AL DAJAN COMPANY - GASIM, KSA** - 722m<sup>2</sup> - Polyurethane sports flooring/Tennis court

-**SELECTIVE GOVERNMENT HIGH SCHOOL - EGYPT** - 720m<sup>2</sup>, Outdoor sports flooring

-**INDIAN AIR FORCE - AHMEDABAD, INDIA** - 720m<sup>2</sup> - Acrylic sports courts

-**FITNESS TIME - FAYSALIA, DAMMAM, KSA** - 700 m<sup>2</sup>-PU indoor multipurpose sports flooring/running track

-**FITNESS TIME YASMEEN - RIYADH, KSA** - 700 m<sup>2</sup> - PU indoor multipurpose sports flooring/running track

-**FERRARI WORLD - ABU DHABI, UAE** - 700m<sup>2</sup> - Playground flooring

-**KOHAT SPORTS COMPLEX - PAKISTAN** - 700m<sup>2</sup> - PU flooring, POLYFLEX PU-IN

-**FITNESS TIME JUNIOR - RIYADH, KSA** - 700 m<sup>2</sup> - PU indoor multipurpose sports flooring/running track

-**FITNESS TIME - OLAYA RIYADH, KSA** - 700 m<sup>2</sup> - PU indoor multipurpose sports flooring/ running track

-**FITNESS TIME WAHA - RIYADH, KSA** - 700 m<sup>2</sup> - PU indoor multipurpose sports flooring/running track

-**FITNESS TIME, NOOR BRANCH - DAMMAM, KSA** -700 m<sup>2</sup> - PU indoor sports flooring and running track

-**FITNESS TIME, ALAMEEN BRANCH - DAMMAM, KSA** - 700 m<sup>2</sup> - PU indoor sports flooring and running track

-**FITNESS TIME, PLUS RIYADH - RIYADH, KSA** - 700 m<sup>2</sup> - PU indoor sports flooring and running track

-**FITNESS TIME, SALAMA BRANCH BRO & FITNESS - JEDDAH, KSA** - 700 m<sup>2</sup> - PU indoor sports flooring

-**FITNESS TIME, 40th BRANCH - JEDDAH, KSA** - 700 m<sup>2</sup> - PU indoor sports flooring and running track

-**NASR CLUB- EGYPT** - 700m<sup>2</sup>, Multipurpose court, POLYFLEX WET-POUR system

-**HUREL DOUBLE 3 - RAS AL KHAIMH, KSA** - 700 m<sup>2</sup> - Shockpad plus acrylic coatings

-**THE SUSTAINABLE CITY - DUBAI, U.A.E** - 700 m<sup>2</sup> - Acrylic flooring

-**PROJECT IN MALTA** - 700 m<sup>2</sup> - Acrylic flooring, SPORTFLOOR-EX system

-**EMAAR - EMIRATES HILLS 2 - DUBAI, U.A.E** - 700m<sup>2</sup> - Basketball court, Acrylic flooring

-**AIRFORCE SURBOTO PARK - NEW DELHI, INDIA** - 680 m<sup>2</sup> - Polyurethane outdoor sports flooring

-**INDIAN ARMY - DHRANGDHARA, INDIA** - 670m<sup>2</sup> - Acrylic sports courts

-**MT.SAINT PATRICK ACADEMY - INDIA** - 665m<sup>2</sup> - Acrylic sports courts

-**RAJIV GANDHI THERMAL POWER PLANT - HISAR, INDIA** - 650m<sup>2</sup> - Acrylic sports courts, FLEXFLOOR-EX

-**JAWAHARLAL NEHRU TECHNOLOGICAL UNIVERSITY ANANTAPURAMU - ANANTAPUR, INDIA** - 650m<sup>2</sup> - Acrylic sports courts, FLEXFLOOR-EX system

-**TILAL HOTEL - DUBAI, U.A.E** - 650 m<sup>2</sup> - SAFEPOL MULTICOLOR system

-**REGIONAL HQ AT BURAIMI - OMAN** - 650 m<sup>2</sup> - Colorflex, PU sport flooring

-**PLAYGROUND FLOORING PROJECT IN LARNAKA, CYPRUS** - 650 m<sup>2</sup> - SAFEPOL MULTICOLOR system

-**ROYAL OMAN POLICE TASK FORCE RUSTAQ - OMAN** - 650 m<sup>2</sup> - Colorflex, PU sport flooring

-**ROYAL OMAN POLICE TASK FORCE LIWA - OMAN** - 650 m<sup>2</sup> - Colorflex, PU sport flooring

-ROYAL OMAN POLICE TASK FORCE AL SALIL - OMAN - 650 m<sup>2</sup> - Colorflex, PU sport flooring

-OUTDOOR TENNIS COURTS - KOSOVO - 650m<sup>2</sup> - Acrylic sports courts, SPORTFLOOR-EX

-ROYAL OMAN POLICE TASK FORCE IBRI - OMAN - 650m<sup>2</sup> - Colorflex, PU sport flooring

-ROYAL OMAN POLICE TASK FORCE IBRA - OMAN - 650m<sup>2</sup> - Colorflex, PU sport flooring

-ROYAL OMAN POLICE TASK FORCE AL SUR - OMAN - 650m<sup>2</sup> - Colorflex, PU sport flooring

-ROYAL OMAN POLICE TASK FORCE AL DUKUM - OMAN - 650m<sup>2</sup> - Colorflex, PU sport flooring

-ROYAL OMAN POLICE TASK FORCE AL BURAIMI - OMAN - 650m<sup>2</sup> - Colorflex, PU sport flooring

-ROYAL OMAN POLICE TASK FORCE AL NIZWA - OMAN - 650m<sup>2</sup> - Colorflex, PU sport flooring

-ROYAL OMAN POLICE TASK FORCE AL SUWAIQ - OMAN - 650m<sup>2</sup> - Colorflex, PU sport flooring

-ABU DHABI MUNICIPALITY - ABU DHABI , UAE - 650m<sup>2</sup> - Acrylic flooring

-ST. MARY'S SCHOOL - LEMESOS, CYPRUS - 650m<sup>2</sup> - Playground flooring, SAFEPOL MULTICOLOR

-ROYAL OMAN POLICE TASK FORCE AL SALALAH - OMAN - 650m<sup>2</sup> - Colorflex, PU sport flooring

-ROYAL OMAN POLICE TASK FORCE AL BARKHA - OMAN - 650m<sup>2</sup> - Colorflex, PU sport flooring

-ROYAL OMAN POLICE TASK FORCE KHOUDH - OMAN - 650m<sup>2</sup> - Colorflex, PU sport flooring

-MULTIPURPOSE COURTS - TIRANA, ALBANIA - 650m<sup>2</sup> - Acrylic sports flooring, FLEXFLOOR system

-PLAYGROUND FLOORING IN KHARKIV-3 - UKRAINE - 650m<sup>2</sup> - SAFEPOL MULTICOLOR system

-MOHAMMED JASSIM M AL THANI SCHOOL - UMSALALALI, QATAR - 620m<sup>2</sup> - PU outdoor sport flooring

-QATAR GEMS SCHOOL - DOHA, QATAR - 615m<sup>2</sup> - Polyurethane sports flooring

-VELOOR THRISSUR DISTRICT - KERALA, INDIA - 610m<sup>2</sup> - Acrylic sports courts, FLEXFLOOR-EX system

-VAISHNO DEVI - DELHI, INDIA - 608m<sup>2</sup> - Polyurethane outdoor sports flooring

-EQUINE FLOORING - BAHRAIN - 600m<sup>2</sup>, POLTRACK EQUESTRIAN SYSTEM

-THAILAND - 600m<sup>2</sup> - Acrylic sports courts

-PLAYGROUND FLOORING IN BAHRAIN - 600m<sup>2</sup> - SAFEPOL MULTICOLOR system

-PLAYGROUND FLOORING IN KHARKIV - UKRAINE - 600m<sup>2</sup> - SAFEPOL MULTICOLOR system

-INDIAN ARMY - AGRA, INDIA - 600m<sup>2</sup> - Acrylic sports courts

-THE INTERNATIONAL SCHOOL - AGRA, INDIA - 600m<sup>2</sup> - Acrylic sports courts

-INDIAN ARMY - JHANSI, INDIA - 600m<sup>2</sup> - Acrylic sports courts

-THE SUSTAINABLE CITY - DUBAI, U.A.E - 600m<sup>2</sup> - Safepol system

-AMITY SCHOOL, JUMEIRAH ISLAND - DUBAI, UAE - 600m<sup>2</sup> - Safepol system

-QUEEN ZAIN AL SHARAF HALL - JORDAN - 600m<sup>2</sup> - POLYFLEX PU-IN

-OUR OWN ENGLISH HIGH SCHOOL - SHARJAH, U.A.E - 600m<sup>2</sup> - Flexfloor system

-OUR OWN ENGLISH HIGH SCHOOL - SHARJAH, U.A.E - 600m<sup>2</sup> - Polyflex Ael-EX system

-ST. FRANCIS INTER COLLEGE - HATHRAS, INDIA - 600m<sup>2</sup> - Acrylic sports courts, FLEXFLOOR-EX system

-ST. ANTHONY'S SENIOR SECONDARY SCHOOL - FARRUKHABAD, INDIA - 600m<sup>2</sup> - FLEXFLOOR-EX

-SKATING FOR KIDS - GUJARAT, INDIA - 600m<sup>2</sup> - Sportfloor system

-IMS COLLEGE - GHAZIABAD, INDIA - 600m<sup>2</sup> - Acrylic sports courts, FLEXFLOOR-EX system

-GALGOTIAS COLLEGE OF ENGINEERING - GR. NOIDA, INDIA -600m<sup>2</sup>-Acrylic sports courts,FLEXFLOOR-EX

-HOTEL COMPLEX IN DHERMI, ALBANIA - 600m<sup>2</sup> - Acrylic sports courts, SPORTFLOOR-EX system

-DANIEL BECCERA OCAMPO EDUCATIONAL INSTITUTION-MONQUEGUA,PERU - 580m<sup>2</sup>POLYFLEX PU-EX

-TATLAY AALI SPORTS COMPLEX - PAKISTAN - 500m<sup>2</sup> - PU flooring,POLYFLEX PU-IN

-NEW DUBAI BRADENTON SCHOOL- DUBAI, UAE - 570m<sup>2</sup> - Acrylic sports courts

-DUBAI SILICON OSIS-CENTRAL PARK, DSO - DUBAI, UAE - 560 m<sup>2</sup> - Jogging track

-MPS WORLD SCHOOL - AGRA, INDIA - 560m<sup>2</sup> - Acrylic sports courts

-LEADERS INTERNATIONAL SCHOOLS - EGYPT - 560m<sup>2</sup> - PU sports courts

**-HARTLAND INTERNATIONAL SCHOOL - U.A.E - 550m<sup>2</sup>- SAFEPOL MULTICOLOR system**  
**-PLAYGROUND FLOORING PROJECT IN SINGAPORE - 550m<sup>2</sup>- SAFEPOL MULTICOLOR system**  
**-ARMY LAW COLLEGE PUNE- PUNE, INDIA - 550m<sup>2</sup>- Acrylic sports courts, FLEXFLOOR-EX system**  
**-AL WUKAIR GIRLS SCHOOL - AL WAKRAH, QATAR - 550m<sup>2</sup> - Polyurethane, outdoor sport flooring**  
**-AL BUROUJ PROJECT, SPORTS CLUB - EGYPT - 550m<sup>2</sup> - Running track, POLTRACK SPRAYCOAT**  
**-PLAYGROUND PROJECT IN CYPRUS - 550m<sup>2</sup>- SAFEPOL MULTICOLOR system**  
**-BBPS - DELHI, INDIA - 512m<sup>2</sup> - Polyurethane outdoor sports flooring**  
**-IVY STATE - PUNE, INDIA - 511m<sup>2</sup>- Acrylic sports courts**  
**-KUNAL ICONIA - INDIA - 510m<sup>2</sup>- Acrylic sports courts**  
**-PORT CISNE - CHILE - 500m<sup>2</sup> - SAFEPOL MULTICOLOR**  
**-AGRICULTURE UNIVERSITY PESHAWAR - INDIA - 500m<sup>2</sup> - Polyurethane sports flooring, POLYFLEX PU-IN**  
**-LJUBUSKY PROJECT - BOSNIA & HERZEGOVINA - 500m<sup>2</sup> - Acrylic sports flooring FLEXFLOOR-EX**  
**-MURIDKE SPORTS COMPLEX-SHEIKHUPURA, PUNJAB, PAKISTAN - 500m<sup>2</sup>-PU flooring,POLYFLEX PU-IN**  
**-CRNA REKA PETROL - NORTH MACEDONIA - 500m<sup>2</sup> - Acrylic flooring, FLEXFLOOR-EX**  
**-ONE PARK AVENUE, SOBHA HARTLAND - U.A.E - 500m<sup>2</sup> - SAFEPOL MULTICOLOR system**  
**-VARIOUS PLAYGROUND PROJECTS IN ABU DHABI - U.A.E - SAFEPOL MULTICOLOR system**  
**-AMERICAN SCHOOL OF DUBAI - DUBAI, UAE - Acrylic sports courts**  
**-ETIHAD MUSEUM - JUMEIRAH, DUBAI, UAE - Rubber flooring**  
**-SHENZHEN CITY VALLEY - CHINA - Acrylic sports flooring**  
**-CARPARKING - ABU DHABI, UAE - Acrylic flooring**  
**-DUBAI MILLENIUM SCHOOL - QUSAIS, UAE - Acrylic sports courts**  
**-AMERICAN UNIVERSITY - DUBAI, UAE – Acrylic outdoor sports flooring**  
**-RAK ACADEMY - RAK, UAE - Acrylic flooring**  
**-ISCS - SHARJA, UAE - Acrylic flooring**  
**-THE INTERNATIONAL SCHOOL OF CHOUEIFAT - AJMAN, U.A.E - Sportground-Ex system**  
**-THE KINDER GARDEN STARTERS - DUBAI, U.A.E - Safepol system**  
**-AL ZAHIA PROJECT - SHARJA, UAE - Safepol system**  
**-WADY DEGLA SHERATON CLUB - CAIRO, EGYPT - Acrylic sports flooring**  
**-PLAYGROUND PROJECT IN QATAR - SAFEPOL MULTICOLOR**  
**-GEMS WELLINGTON SCHOOL - DUBAI, U.A.E - Safepol system**  
**-JUMEIRAH RETAIL DEVELOPMENT - JUMEIRAH, DUBAI, UAE - Safety rubber flooring**  
**-MR.ABDULRHMIN - JUBAIL, KSA - Rubber playground**  
**-GEMS WESTMINISTER SCHOOL - DUBAI, U.A.E - Safepol system**  
**-POLYURETHANE INDOOR SPORTS COURT - TIRANA, ALBANIA - Polyflex PU-In system**  
**-MULTIPURPOSE COURTS - ODESSA, UKRAINE - Rubber flooring**  
**-MULTIPURPOSE COURTS - ZHOVKVA, UKRAINE - Rubber flooring**  
**-MUNICIPAL TENNIS CLUB - PATRA, GREECE - Flexfloor-EX system, Acrylic sports courts**  
**-INDIAN AIR FORCE - GORAKHPUR, INDIA - Acrylic sports courts**  
**-INDIAN AIR FORCE - BAREILLY, INDIA - Acrylic sports courts**  
**-INDIAN ARMY - BABINA, INDIA - Acrylic sports courts**  
**-ADAM AIRBASE PACKAGE 8, OMAN - Colorflex, PU sport flooring**  
**-GOLD GYM - KOLKATTA, INDIA - Polyurethane indoor sports flooring**  
**-MINISTRY OF FOREIGN AFFAIRS - ABU DHABI, UAE - Polyurethane flooring**  
**-SHRJAH SPORTS CLUB - SHARJAH, UAE - Polyurethane flooring**

-GEMS WINCHESTER SCHOOL - AL BARSHA SOUTH, UAE - Acrylic sports system

-HOTEL DOUBLE 3 - RAS AL KHAIMAH, UAE - Prefabricated shock-pad 4mm plus acrylic coatings

-ALNABBAGH STABLE - AL AIN, U.A.E - Polyurethane flooring, POLTRACK EQUESTRIAN FLOORING

-AL WAHDA CLUB - ABU DHABI, UAE - Rubber flooring

-ADJD MAIN BUILDING LANDSCAPE PROJECT - ABU DHABI, UAE - Rubber flooring

-KADEEJ AL KURBA SCHOOL - ABU DHABI, UAE - Rubber flooring

-INTERNATIONAL SCHOOL OF CREATIVE SCIENCE-SHARJA, U.A.E-Flexfloor system/Outdoor Multipurpose court

-ENVIRO, VATIKA HOTELS PVT.LTD - GURGAON, INDIA - Acrylic sports flooring

-ASHIANA - BHUBANESHWAR, INDIA - Acrylic sports flooring

-TCS, ADIBATLA - HYDERABAD, INDIA - Acrylic sports flooring

-IPS, ERODE - CHENNAI, INDIA - Acrylic sports flooring

-LIONS GATE - MUMBAI, INDIA - Acrylic sports flooring

-MORNING GLORY INFRA LIMITED - KANPUR, INDIA - Acrylic sports flooring

-SPORTS HALL ZVORNIK - BOSNIA & HERZEGOVINA - PU flooring POLYFLEX PU-IN

-NAMBIAR - BANGALORE, INDIA - Acrylic sports flooring

-PATHWAYS - GURGAON, INDIA - Acrylic sports flooring

-WELHAMS GIRLS SCHOOL - DEHRADUN, INDIA - Acrylic sports flooring

-WOODDUCK COMMERCIAL CENTER- IRAN - Industrial flooring

-ARABIAN RANCHES by EMAR - DUBAI, U.A.E - Playground flooring

-OUR OWN ENGLISH HIGH SCHOOL - SHARJAH, U.A.E - Playground flooring

-POLO CLUB GHANTOOT - ABU DHABI, U.A.E - Polyurethane flooring, POLTRACK EQUESTRIAN FLOORING

-RAK MODERN SCHOOL - RAS AL KHAIMAH, U.A.E - Playground flooring

-GIIS/GLOBAL INDIAN INTERNATIONAL SCHOOL - RAS AL KHAIMAH, U.A.E - Playground flooring

-MINISTRY OF EDUCATION, NAD AL HAMAR BOYS SCHOOL - DUBAI, U.A.E - Playground flooring

-K.G. KIDS SCHOOL - AALI, BAHRAIN - Playground flooring

-SABIC BEACH CAMPS PROJECT - JUBAIL, K.S.A - Outdoor sports flooring, artificial grass.

-MINISTRY OF EDUCATION, MIZHER GIRLS SCHOOL - DUBAI, U.A.E - Playground flooring

-WARSAN STABLE - Polyurethane flooring, POLTRACK EQUESTRIAN FLOORING

-AL SHIMAL PARK - DOHA, QATAR - Playground flooring

-UM SELAL PARK - DOHA, QATAR - Playground flooring

-GEMS METROPOLE SCHOOL - DUBAI, U.A.E - Hard court system/Outdoor Multipurpose court

-ARABIAN RANCHES by EMAR - DUBAI, U.A.E - Acrylic Outdoor Tennis and Basketball courts

-RAK MODERN SCHOOL - RAS AL KHAIMAH, U.A.E - Flexfloor system

-GIIS/GLOBAL INDIAN INTERNATIONAL SCHOOL - RAS AL KHAIMAH, U.A.E - Acrylic system

-AVALON HEIGHTS - AJMAN, U.A.E - Acrylic floorings

-DELHI PRIVATE SCHOOL - DUBAI, U.A.E - Acrylic flooring

-ROYAL COMMISSION SCHOOL - JUBALI, KSA - Acrylic sports flooring

-FITNESS TIME PRO - AL AHSA BRANCH - KSA - Flexfloor, Basketball court

-FITNESS TIME PRO - MAKKAH SHARAIE - KSA - Flexfloor, Basketball court

-BIN HAM - AL AIN, UAE - Polyurethane flooring

-SHAMMA BINT MOHAMMED SHOOL - AL AIN, UAE - Polyurethane flooring

-ABDULLAH BIN OTAIBA - ABU DHABI, UAE - Polyurethane flooring

-LIWA INTERNATIONAL SCHOOL - AL AIN, U.A.E - Colorflex outdoor sport system

-ZOHOUR KG - MANAMA, BAHRAIN - Polyurethane sports flooring

**-RAWDA RASHED - QATAR-** Polyurethane, outdoor sport flooring

**-SAAD BIN ABI WAQAS SCHOOL - AL RAYYAN, QATAR** - Polyurethane, outdoor sport flooring

**-FITNESS TIME PRO - MADINS RING ROAD BRANCH - KSA** - Flexfloor, Basketball court

**-AGRA CHAIN - AGRA, INDIA** - Acrylic sports flooring

**-SUNWORLD - NOIDA, INDIA** - Acrylic sports flooring

**-SSN INVESTMENTS PRIVATE LIMITED, FRIENDS COLONY - DELHI, INDIA** - Acrylic sports flooring

**-AJNARA - NOIDA, INDIA** - Acrylic sports flooring-**BRIGHT RIDERS SCHOOL - ABU DHABI, UAE** - Running track, Acrylic sports court

**-OUR OWN ENGLISH HIGH SCHOOL - SHARJAH, U.A.E** - Poltrack Spaycoat system

**-NCC - JAIS, INDIA** - Acrylic sports flooring

**-ALPHA FOUNDATION FOR EDUCATION & RESEARCH - TRICHIRAPALLI, INDIA** - Acrylic sports flooring

**-PUSHPANJALI FARMS - NEW DELHI, INDIA** - Acrylic sports flooring

**-M3M - MERLIN GURGAON, INDIA** - Acrylic sports flooring

**-NORTH LONDON COLLEGIATE SCHOOL - DUBAI, U.A.E** - Playground flooring

**-FOOT COURT - EGYPT** - Running track, POLTRACK SPRAYCOAT system

**-FITNESS TIME ANDALUS BRANCH - JEDDAH, K.S.A** - Acrylic sports flooring, FLEXFLOOR SYSTEM

**-ST.JOSEPHS WOMENS COLLEGE - ALLEPPEY, KERALA, INDIA** - Polyurethane outdoor sports flooring

**-RAILWAY SPORTS GROUND - GUNTAKAL, ANDRA PRADESH, INDIA** - Acrylic sports flooring

**-TERVEL PROJECT - TERVEL, BULGARIA** - Playground flooring, SAFEPOL system

**-INDOOR COURT - UKRAINE** - Polyflex PU-In system

**-PRIVATE JOB - HYDERABAD, SOUTH INDIA** - Acrylic outdoor sports flooring

**-RAILWAY SPORTS GROUND -GUNTAKAL, ANDRA PRADESH, INDIA**-Acrylic outdoor sports flooring, 5 layers

**-MINISTRY OF EDUCATION U.A.E** - Playground flooring

**-PLAYGROUND FLOORING - VARNA, BULGARIA** - SAFEPOL System

**-INDIAN ARMY - SHAHJAHANPUR, INDIA** - Acrylic sports courts, FLEXFLOOR-EX system

**-AIR FORCE SCHOOL - BENGALURU, INDIA** - Acrylic sports courts, FLEXFLOOR-EX system

**-ARMY PUBLIC SCHOOL - UDHAMPUR, INDIA** - Acrylic sports courts, FLEXFLOOR-EX system

**-BAHRAIN ROYAL EQUESTRIAN AND ENDURANCE FEDERATION - BAHRAIN** - PU Equestrian system

**-PLAYGROUND PROJECT - HONG KONG** - SAFEPOL MULTICOLOR system

**-PLAYGROUND PROJECT - KOSOVO** - SAFEPOL MULTICOLOR system

**-KIND SAUDI UNIVERSITY - RIYADAH, K.S.A** - Running track, POLTRAC SPRAYCOAT ASYSTEM

**-TENNIS COURT IN MYKONOS, GREECE** - Acrylic sports courts, POLYFLEX AEL-EX system

**-TENNIS COURT PROJECT - PAKISTAN** - Acrylic sports courts, SPORTFLOOR-EX-R system

**-SHENZHEN CITY VALLEY - CHINA** - Acrylic sports courts

**-QAYYUM STADIUM PESHAWAR - INDIA** - Polyurethane flooring POLYFLEX PU-IN

**-PLAYGROUND FLOORING IN CYPRUS** - SAFEPOL MULTICOLOR system

**-PLAYGROUND FLOORING - PRNJAVOR, BOSNIA & HERZEGOVINA** - SAFEPOL MULTICOLOR system

**-VARIOUS PLAYGROUND PROJECTS IN ABU DHABI - U.A.E** - SAFEPOL MULTICOLOR system

**-POLYURETHANE OUTDOOR SPORTS COURT - QATAR** - POLYFLEX PU-EX system

**-QASR AL SARAB DESERT RESORT - ABU DHABI, U.A.E** - SAFEPOL MULTICOLOR

**-SPORTS CENTER IN HANOI - VIETNAM** - POLYFLEX PU-IN

**-NIELSON BUKA RESORT - KALAMATA, GREECE** - FLEXFLOOR-EX

# PHOTOGRAPHS OF PROJECTS



# PLAYGROUND FLOORING

## SAFEPOL SANDPROOF

Innovative, elastic, seamless, flexible colored flooring **with sandproof properties**, ideal for school courtyards and playground flooring.

It consists of a cushion base of 2 layers. First layer is a mixture of **PU BINDER 1178** and **RECYCLED RUBBER 858** (granulometry 2-4mm or 2-5mm), in thickness of 30-110mm. Second layer is a mixture of **PU BINDER 1178** and **RECYCLED RUBBER 858** (granulometry 0,5-2mm) in thickness of 10mm. Then follows the **modified sealing, sandproof and waterproof KDF-PU 1055 pore filler** with high elasticity in 2 crossing layers followed by the polyurethane self-leveling **POLYSPORT PU 1051** and then the **modified, KDF-PU 1056, sealing, UV-resistant, aliphatic, elastic, glossy top layer** in 3 crossing layers.

**Certified system by TUV and LABOSPORT Institute.**

### Steps:

**1. PU PRIMER 870 - Special, polyurethane primer.**

Applied by brush or airless sprayer on asphalt surfaces or on waterproof concrete surfaces without rising humidity issues.

**2. Mixture of PU BINDER 1178 and RECYCLED RUBBER 858 in granulometry of 2-4mm or 2-5mm.** Application with paving machine, in thickness of 30-110mm.

**3. Mixture of PU BINDER 1178 and RECYCLED RUBBER 858 in granulometry of 0.5-2mm.** Application with paving machine, in thickness of 10mm.

**4. KDF-PU 1055 - Polyurethane, modified, sandproof and waterproof, elastic pore filler.** Applied by metal trowel to create a completely non porous surface.

**5. POLYSPORT PU 1051 - Polyurethane, self-leveling, two-component coat for outdoor surfaces.** Applied by V-notch trowel and the parallel use of spiked roller.

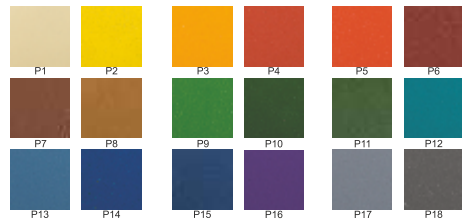

**6. KDF-PU 1056 - Polyurethane, modified, UV-resistant, aliphatic, elastic, glossy, two-component top coating.** Applied, in two crossing layers by airless sprayer or short haired mohair roller.

Description	Consumption
PU PRIMER 870 - Special, polyurethane primer.	0.2-0.3kg/m <sup>2</sup> for 2 layers
PU BINDER 1178 - Special, polyurethane binder.	1kg/m <sup>2</sup> for 10mm mixture
RECYCLED RUBBER 858 - SBR granules in granulometry of 2-4mm or 2-5mm.	6kg/m <sup>2</sup> for 10mm mixture
PU BINDER 1178 - Special, polyurethane binder.	1.2kg/m <sup>2</sup> for 10mm mixture
RECYCLED RUBBER 858 - SBR granules in granulometry of 0.5-2mm.	6kg/m <sup>2</sup> for 10mm mixture
KDF-PU 1055 - Polyurethane, modified, sandproof and waterproof, elastic pore filler.	1.5kg/m <sup>2</sup> for 2 layers
POLYSPORT PU 1051 - Polyurethane, self-leveling, two-component coat for indoor sports surfaces.	2.2kg/m <sup>2</sup> for 1 layer
KDF-PU 1056 - Polyurethane, modified, UV-resistant, aliphatic, elastic, glossy, two-component top coating, protection against UV radiation.	0.3kg/m <sup>2</sup> for 2 layers

## SAFEPOL SANDPROOF SYSTEM

### Playground, safety flooring

---



Innovative, elastic, seamless, flexible colored flooring with sandproof properties, ideal for school courtyards and playground flooring.

It consists of a cushion base of 2 layers. First layer is a mixture of **PU BINDER 1178** and **RECYCLED RUBBER 858** (granulometry 2-4mm or 2-5mm), in thickness of 30-110mm. Second layer is a mixture of **PU BINDER 1178** and **RECYCLED RUBBER 858** (granulometry 0,5-2mm) in thickness of 10mm. Then follows the modified sealing, sandproof and waterproof **KDF-PU 1055** pore filler with high elasticity in 2 crossing layers followed by the polyurethane self-leveling **POLYSPORT PU 1051** and then the modified, **KDF-PU 1056**, sealing, UV-resistant, aliphatic, elastic, glossy top layer in 3 crossing layers.

**Certified system by TUV and LABOSPORT Institute.**

#### Steps

1. **PU PRIMER 870 - Special, polyurethane primer.** Applied by brush or airless sprayer on asphalt surfaces or on waterproof concrete surfaces without rising humidity issues.
2. **Mixture of PU BINDER 1178 and RECYCLED RUBBER 858 in granulometry of 2-4mm or 2-5mm.**  
Application with paving machine, in thickness of 30-110mm.
3. **Mixture of PU BINDER 1178 and RECYCLED RUBBER 858 in granulometry of 0.5-2mm.** Application with paving machine, in thickness of 10mm.
4. **KDF-PU 1055 - Polyurethane, modified, sandproof and waterproof, elastic pore filler.** Applied by metal trowel to create a completely non porous surface.
5. **POLYSPORT PU 1051 - Polyurethane, self-leveling, two-component coat for outdoor surfaces.** Applied by V-notch trowel and the parallel use of spiked roller.
6. **KDF-PU 1056 - Polyurethane, modified, UV-resistant, aliphatic, elastic, glossy, two-component top coating.** Applied, in two crossing layers by airless sprayer or short haired mohair roller.

#### Preparation – Application

**Applied only on dry asphalt and concrete surfaces (over 30 days old from date of placement for asphalt and 40 days for concrete) without rising humidity issues and free of materials that might prevent bonding e.g.**

**dust, loose particles, grease etc.** The success in the application depends on the right preparation of the underlay and use of the material.

- **Good, dry** cleaning of the surface from dust and residues.
- Priming of the surface with special **POLYURETHANE PRIMER 870** in two layers. Consumption: 200-250 gr/m<sup>2</sup>, depending on the absorption of the underlay. It is recommended that the second layer should be applied in sections each time, right before the application of the mixture of **PU BINDER 1118** and **RECYCLED RUBBER 858** (mixture **SAFEPOL**) in order to ensure proper adhesion, especially on the edges and endings of the playground flooring.
- After 5-12 hours and when the primer is almost dry but not completely, application of the **mixture of PU BINDER 1118 and SBR granules, in granulometry 2-4mm or 2-5mm** with paver machine to have the appropriate elasticity on the subfloor, in thickness of 30-110mm. Consumption 7kg/m<sup>2</sup>/cm.
- Then when the first cushion surface is dry, application with paver machine of a mixture of **PU BINDER 1118 with SBR granules in granulometry 0,5-2mm** in thickness of 10mm. Consumption 7.2kg/m<sup>2</sup>/cm.
- Afterwards when the surface of SBR is dry, application of **polyurethane, modified, sandproof and waterproof, elastic pore filler KDF-PU 1055 with metal trowels to create a completely non porous surface.** Consumption: 2 7kg/m<sup>2</sup> for 2 layers.
- The next day, depending ambient temperature, follows application of **POLYSPORT PU 1051**. Components A (resin) & B (hardener). The mixed material must be used within 20-30 minutes of mixing at 25°C. The polyurethane mixture is poured on the floor and spread using V-notch trowel, 5,5mm. Consumption: 2,0 - 2,2 kg/m<sup>2</sup> in one layer.
- Following the application of **POLYSPORT PU 1051**, the self-leveling layer should be rolled using a special spiky-roller in order to release any possibly entrapped air and avoid the formation of bubbles. Sanding of the surface should be done after drying.
- Before the last **UV-resistant top layers** are applied, the surface needs the use of sandpaper machine to make a completely even surface without any irregularities or loose crumbs.
- After the sandpaper of the whole surface is finished follows the application of 350 gr/square meter of our **polyurethane, modified, UV-resistant, aliphatic, elastic, glossy, two-component top coating KDF-PU 1056** in three cross layers by airless spray or by rollers.

### Important Remarks

- ✓ During temperatures over 40 degrees, ideal time for the application of **SAFEPOL SANDPROOF** is between 22:00 and 09:00 and the minimum bearing temperature during application and drying should be over 10°C.
- ✓ In case the second layer of PU pore filler **KDF-PU 1055** is applied after more than 24 hours of the application of the first one then the whole surface must be sanded by a special sanding machine. After that the second layer can be applied.
- ✓ In case the layer of PU self-leveling **POLYSPORT PU 1051** is applied after more than 24 hours of the application of the last layer of PU pore filler then the whole surface must be sanded by a special sanding machine. After that the PU self-leveling can be applied.
- ✓ In case the second layer of PU top coat is applied after more than 24 hours of the application of the first one then the whole surface must be sanded by a special sanding machine. After that the second layer can be applied.
- ✓ The freshly coated surface should be protected from high temperatures, wind, rain and frost for at least the first 24 hours.

## Substrate

**Asphalt is the safer subfloor for sport floorings for sure and must be always preferred than concrete surfaces.**

### **A. Asphalt Substrate**

**The asphalt must have a slope of 0.7-1% and must dry for at least 30 days so that all solvents from the asphalt can evaporate.**

The asphalt sub-floor should be applied on well compacted 150mm road base sub-floor and asphalt should be laid in one layer (and not 2) in 6 to 8cm with fine and coarse aggregates (up to 15mm granulometry) like the kind of asphalt used in road construction.

So, new road-grade asphalt will have to be laid (minimum 60mm) in one layer containing coarse aggregates and then mature for 30 days at least, before any application takes place on top of the asphalt to avoid bubbles on the final layer of the sport or rubber floorings.

#### Asphalt Infrastructure

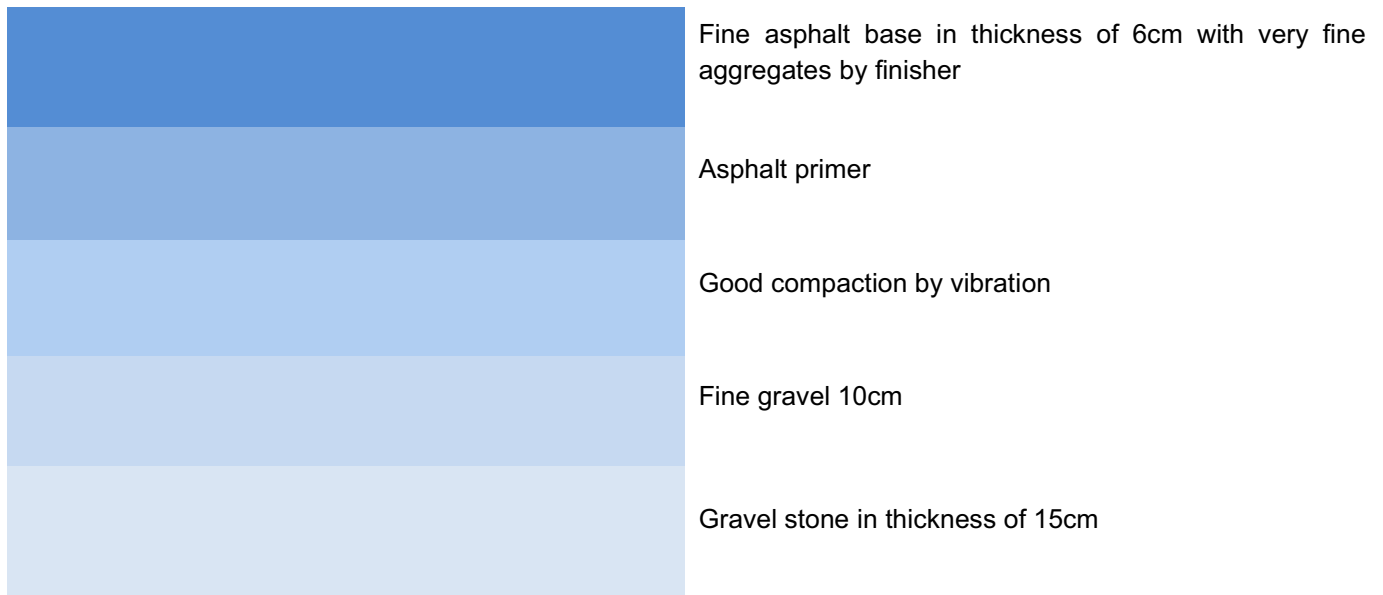

### **B. Concrete Surface**

**Concrete surface must be power-trowelled without cracks and must be smooth with a slope of 0.7-1% and humidity under 4% in 10cm depth of concrete.**

Concrete must also be **dry at least for 40 days** and then the application takes place if there is no rising humidity for the sub-floor. Before the application takes place, there must be proper grinding of the surface by a grinding machine to open the pores accordingly and also a measurement by special instrument to measure humidity on the surface and in 10cm under the surface.

Generally concrete is a risky sub-floor and there may be problems with rising humidity, especially in areas where the sea level is really high and when the sea is close or in areas near greenery.

**Always make expansion joints in large areas of concrete, in order to avoid uncontrollable cracks and failures.**  
Joints should be every 25 square meters creating a grid of 5x5 meters or close to that.

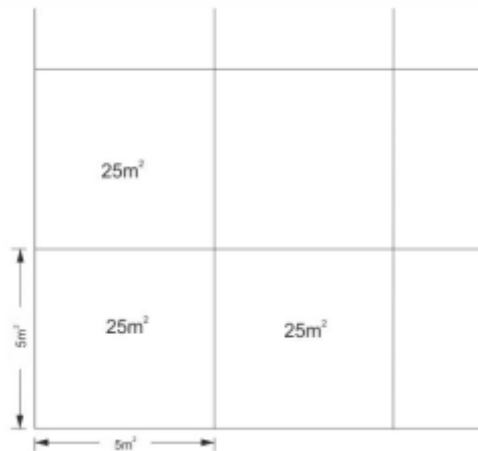

### Substrate requirements

Concrete quality	at least C20/25
Age:	at least 40 days
Moisture content:	below 4%

### Tools:





The colors may vary slightly from the original due to digital representation.



The colors may vary slightly from the original due to digital representation.

# PU PRIMER 870

TRANSPARENT, ONE COMPONENT, POLYURETHANE-BASED PRIMER, USED AS AN ADHESIVE COMPONENT BETWEEN SUBFLOOR AND SPORTS SYSTEMS

## GENERAL CHARACTERISTICS

**POLYURETHANE PRIMER 870** is a clear, polyurethane-based, one-component primer, which is used as an adhesive component between the sub-floor and sport systems.

- ✓ Penetrates in depth.
- ✓ Ideal for old and new surfaces.

## TECHNICAL DATA

Basis:	one-component polyurethane
Appearance:	liquid
Color:	transparent
Viscosity:	100 – 500 mPa s at 25°C
Density:	0.9- 1.0 Kg/Lt
Temperature for the application and drying of the material:	10 – 40°C

## PREPARATION-APPLICATION

**Applied on dry surfaces without rising humidity issues, free of materials that might prevent bonding e.g. dust, loose particles, grease etc (in case of asphalt or concrete).**

The success in the application depends on the right preparation of the underlay and use of the material.

- **Good, dry** cleaning of the surface from dust and residues.
- Priming of the surface with **PU PRIMER 870** applied by airless sprayer equipment or brush or roller. The base layer (wet-pour mixture of SBR and **PU BINDER 1118**) should be constructed while **PU PRIMER 870** is still a bit sticky. Curing takes place at ambient temperature by evaporation of the solvent and reaction with atmospheric moisture. High temperatures and moisture will shorten the curing time. **PU PRIMER 870** is applied in two or more layers as a thin film, and on the final layer, the wet-pour mixture of SBR and **PU BINDER 1118** can be applied on the still sticky surface.
- The temperature should not fall below 10° C during curing.
- Opened drums should be used up quickly.
- The layer (wet-pour mixture of SBR and **PU BINDER 1118**) should be constructed while the final layer of **PU PRIMER 870** is still sticky.
- **NOTE: Rain will cause the primer to lose its function! If the primer was affected by rain, the base layer should not be constructed! Instead, the sub floor has to dry and the primer application has to be repeated.**

## CONSUMPTION

200-300 gr/m<sup>2</sup> depending on the type and the absorbency of the underlay.

## APPLICATION TOOLS

Brush, roller or airless sprayer. Tools should be cleaned with a PU solvent immediately after use.



---

## PACKAGING

Drums / Barrels.



---

## STORAGE

One year in unopened containers in cool and dry places, out of sunlight, with minimum temperature 5°C and maximum temperature 30°C.

---

## REMARKS

- Working time of **POLYURETHANE PRIMER 870** decreases when ambient temperature rises.
- Prolonged storage of partially used containers containing **POLYURETHANE PRIMER 870** must be avoided as contact with atmospheric moisture will result in skinning and clouding of the product.

---

## CAUTION

The application must take place in well-aired places using protective gloves. Skin or eye contact must be avoided, otherwise wash carefully with soap and water.

**For more information consult the safety data sheet.**

---

The information given here is true, represents our best knowledge and is based not only on laboratory work, but also on field experience. However, because of numerous factors affecting results we offer this information without any guarantee and no patent liability is assumed. For additional information or questions, contact the technical department of KDF LTD.

# PU BINDER 1178

## SPECIAL POLYURETHANE BINDER

### GENERAL CHARACTERISTICS

100% solids, aromatic polyisocyanate-prepolymer moisture-curing binder based on diphenylmethane diisocyanate. It is MDI based and solvent free. It exhibits excellent adhesion to all rubber granules and gives a strong performance both in terms of tensile strength and durability.

It is mixed with **RECYCLED RUBBER 858, SBR granules**, for the creation of the innovative, elastic, safety playground flooring **SAFEPOL SANDPROOF SYSTEM** or other flexible rubber floorings, ideal for playgrounds, schools etc.

**PU BINDER 1178** cured with the air humidity, has low viscosity and is solvent free. **PU BINDER 1178** combines and bonds SBR or EPDM rubber granules, RIM components, polyurethane granules and sponge particles. Also it can be used as lining for insulation and for pasting.

### TECHNICAL DATA

Density (25°C)	1,08-1,18 kg/l
Viscosity (25°C)	4000-8000 mPas
Color	Clear, pale yellow

### SUBSTRATE REQUIREMENTS

Concrete quality:	at least C20/25
Age:	at least 30 days
Moisture content:	below 4%

### PREPARATION-APPLICATION

**On-site applications: Applied on dry surfaces, free of materials that might prevent bonding e.g. dust, loose particles etc (in case of asphalt or concrete).** The success in the application depends on the right preparation of the underlay and use of the material.

- **Good, dry** cleaning of the surface from dust and residues.
- Priming of the surface with the special **POLYURETHANE PRIMER 870** in two layers. It is recommended that the second layer should be applied in sections each time, right before the application of **PU BINDER 1178** and **SBR granules** in order to ensure proper adhesion.
- Good mixing of the **PU BINDER 1178** and the **RECYCLED RUBBER 858 in granulometry of 2-4mm or 2-5mm**. Mixing should be performed using a low revolution mixer (300-600 rpm) for 1-2 min. Stirring of the mixture should be performed thoroughly near the sides and bottom of the container in order to achieve homogeneity.
- Following, the mixture is poured on the surface and spread on the desired thickness using paving machine or it can be done manually if the applicator is experienced, with rake for spreading, (wooden) straightedge for initial smoothing, flat metal trowel for final smoothing and compacting, cylinder weighing 8-15kg for final compacting-(cylinder should be cleaned repeatedly with diesel to remove stuck granules from its surface). Consumption: 7kg/m<sup>2</sup>/cm.
- Good mixing of the **PU BINDER 1178** and the **RECYCLED RUBBER 858 in granulometry of 0.5-2mm**. Mixing should be performed using a low revolution mixer (300-600 rpm) for 1-2 min. Stirring of the mixture should be performed thoroughly near the sides and bottom of the container in order to achieve homogeneity.
- Following, the mixture is poured on the surface and spread on the desired thickness using paving machine or it can be done manually if the applicator is experienced, with rake for spreading, (wooden) straightedge for initial smoothing, flat metal trowel for final smoothing and compacting, cylinder weighing 8-15kg for final compacting-(cylinder should be cleaned repeatedly with diesel to remove stuck granules from its surface). Consumption: 7,2kg/m<sup>2</sup>/cm.

- Follows the application of **KDF-PU 1055** a special waterproof and sandproof, polyurethane pore filler for sealing the pores of the mixture.
- Then follows the application of **POLYSPORT PU 1051** a polyurethane self-leveling before the application of the final top coating.
- And finally a top coat is applied, **KDF-PU 1056**, polyurethane, modified, UV-resistant, aliphatic, elastic, glossy, two-component top coating.

---

## APPLICATION TOOLS

For the mixture **PU BINDER 1118** and **RECYCLED RUBBER 858** or: paver machine or rake, straightedge, flat metal trowel, cylinder weighing 8-15kg



---

## PACKAGING

220kg in barrels.



---

## STORAGE

One year in unopened containers in dry places with minimum temperature 5°C and maximum temperature 30°C, protected from moisture and heat.

---

## REMARKS

The floor must be smooth, dry and clean. Must be removed from oil, dirt, rust and burr. Do not add any foreign material. Concrete humidity should not be above 4%, ambient humidity should be at least 40% and most 80%. To begin the application, must wait for the appropriate humidity

Working time of **PU BINDER 1178** decreases when ambient temperature rises.

Prolonged storage of partially used containers containing **PU BINDER 1178** must be avoided as contact with atmospheric moisture will result in skinning and clouding of the product.

---

## CAUTION

The application must take place in well-aired places using protective gloves. Skin or eye contact must be avoided, otherwise wash carefully with soap and water.

**For more information consult the material safety data sheet.**

---

The information given here is true, represents our best knowledge and is based not only on laboratory work, but also on field experience. However, because of numerous factors affecting results we offer this information without any guarantee and no patent liability is assumed. For additional information or questions, contact the technical department of KDF LTD.

# SBR RUBBER GRANULES 858

## GENERAL CHARACTERISTICS

It can be used in sports facilities as infill in synthetic grass with the parallel use of round sand and also as one of the components in case of cast applied wet-pour systems for playground floorings or as shock-pad for sport subfloors in athletic tracks and sports fields.

Rubber granule is derived from car and truck tires. During processing, the tires are mechanically granulated, removing all metal and synthetic fibers, as well as any other foreign part contained in there with specially designed sieves, so as to produce a 99.99% clear rubber with high quality.

## PROPERTIES

- 100% recyclable
- Long life
- Resistance to adverse weather conditions
- High shock absorbency and vibration damping
- High abrasion resistance

## PREPARATION-APPLICATION

In sports facilities and playgrounds to ensure flexibility of surface and vibration absorption.

## TECHNICAL CHARACTERISTICS

### Granulometry 1-3mm

DENSITY:	0.48kg/cm <sup>3</sup>
SPECIFIC GRAVITY	1.20+/-0.05 (Water = 1.0)
HARDNESS	60
HUMIDITY(%)	<0.65
ELASTICITY	100% - No change
RESISTANCE	113N/cm - Excellent

## PACKAGING

Packaging is available in big-bags -1 ton in following sizes:

Grain size	0,5-1,5 mm
Grain size	0,5-2,5 mm
Grain size	0.5-4.0 mm
Grain size	2-8 mm
Grain size	8-20 mm
Grain size	80-50 mm
Grain size	80-120 mm



---

The information given here is true, represents our best knowledge and is based not only on laboratory work, but also on field experience. However, because of numerous factors affecting results we offer this information without any guarantee and no patent liability is assumed. For additional information or questions, contact the technical department of KDF LTD.

# KDF-PU 1055 PORE FILLER

## FOR SANDPROOF-WATERPOOF PLAYGROUND FLOORINGS

### GENERAL CHARACTERISTICS

**KDF-PU 1055 PORE FILLER** is a sealing, sandproof and waterproof modified pore filler with high elasticity that can be applied over SBR cushion layers.

**KDF-PU 1055 PORE FILLER** resists against sand penetration/ depositing, humidity, water and most of the chemicals. It has very good filling capacity and thixotropic properties. It has low fluidity feature with its filler structure. It can be easily applied. It provides strong and very elastic filling after the reaction.

### TECHNICAL DATA

Mixing Ratio	88.64 : 11.36 (By weight)
Density of mixture (25°C)	1.50-1.60 Kg/lt
Viscosity of mixture (25°C)	70.000-90.000 mPa s at 25°C
Pot-life (25°C)	30-40 min
Application temperature	Min 10°C
Curing (25°C and %60 relative humidity)	After 24 hours it can be sanded
Color	Creme

### PREPARATION-APPLICATION

It is used to fill pores, cracks, dilation spaces, holes to smooth and repair the floor and other filling applications.

Especially used for sealing and sandproofing in-situ applied SBR (or EPDM) layers in **SAFEPOL SANDPROOF** system

- The resin component should be thoroughly stirred to incorporate any slight separation, whilst continuing stirring the contents of the hardener container should be added.
- Continue stirring until a homogeneous mix is obtained.
- The mixed material must be used within 30-40 minutes of mixing at 25°C The surface must be dry and clean.
- **KDF-PU 1055 PORE FILLER** can be applied by trowel.

### CONSUMPTION

2 kg per m<sup>2</sup> (depends on the surface absorbance and SBR granulation).

### APPLICATION TOOLS

Flat metal trowel.



---

## PACKAGING

Barrels 280kg.



---

## STORAGE

One year in unopened containers in cool and dry places, out of sunlight, with minimum temperature 5°C and maximum temperature 30°C.

---

## REMARKS

- Substrate must be dry, clean, and free from dust, grease and oil. Application must be done between 10°C - 40°C.
- **KDF-PU 1055 PORE FILLER** has to be thoroughly sanded before the application of the top aliphatic coat **KDF-PU 1056 TOP COATING** in order to provide a smooth clean surface for the aliphatic top coat that will follow right after the sanding process is completed.
- By no means **KDF-PU 1055 PORE FILLER** should be applied in thickness. The material is a pore filler and not a levelling material, and so it should be applied as pore filler (thin dragged layer over the substrate). In case it is applied in some areas in thickness, those areas should be well ground with sanding machine before subsequent layers in order to avoid cracking of the material due to oversized thickness.
- Attention should be given also to possible trapped humidity in the pore filler, which could lead to cracks in the material or bubbles of the material.
- Moreover, it is important that the mixing ratio between PU BINDER to SBR or EPDM rubber in the underlying cushion mixtures is kept as stable as possible in order to obtain similar flexibility of the cushion throughout the surface. Otherwise, areas with different flexibilities might occur. Same can happen if the mixing is not properly done in the paving machine or in the barrels/drums to secure uniformity throughout.

---

## CAUTION

Harmful if swallowed. Seek immediately medical attention. Rubber gloves and safety glasses with side guards should be worn.

**For more information consult the material safety data sheet.**

---

The information given here is true, represents our best knowledge and is based not only on laboratory work, but also on field experience. However, because of numerous factors affecting results we offer this information without any guarantee and no patent liability is assumed. For additional information or questions, contact the technical department of KDF LTD.

# POLYSPORT PU 1051

## POLYURETHANE, SELF-LEVELING, TWO-COMPONENT COATING

### GENERAL CHARACTERISTICS

**POLYSPORT PU 1051** is a solvent-free, polyurethane-based, two-component, self-leveling coating for outdoor sport surfaces.

**POLYSPORT PU 1051** has excellent mechanical properties; like high impact.

It is applied on prefabricated subfloors of sports flooring such as **ISOPOL 854**, shock-pad in rolls, or wet-pour rubber cushion mix of SBR rubber granules and **PU BINDER 1118** after they are sealed with elastic pore sealer **POLYSPORT STUCCO 1050**. Combines finally polyurethane finish paint **POLYSPORT 1052** for the creation of a multilayer polyurethane floor especially designed for sport halls such as tennis, basketball, handball, volleyball and multipurpose halls.

- Applies easily with trowel, providing excellent self-leveling properties.
- Highly flexible and elastic contributing in the athletic performance of the flooring.
- Non shrinking.

### TECHNICAL DATA

Mixing Ratio (By weight)	86.96 : 13.04 By weight
Density (25°C) mixture	1.40 – 1.50 Kg/Lt
Viscosity(25°C)	3.500 – 8.000 mPa s at 25°C
Pot-life (25°C)	20 - 30 min at 25° C
Hardness (Shore A)	80
Application temperature	10 – 40 °C
Curing (25°C and %60 relative humidity)	After 24 hours
Color	KDF's Color chart

### PREPARATION-APPLICATION

**Applied on dry surfaces without rising humidity issues, free of materials that might prevent bonding e.g. dust, loose particles, grease etc (in case of asphalt or concrete).** The success in the application depends on the right preparation of the underlay and use of the material.

- **Good, dry** cleaning of the surface from dust and residues using vacuum cleaner and squeegees.
- Caution must be taken so that temperature of the support surface as well as ambient air remains above 10° C during application and curing of the materials while relative humidity does not exceed 75%.
- Depending on the ambient temperature, follows application of **POLYSPORT PU 1051**. Components A & B (hardener) packed into separate containers in fixed weight proportions are mixed together using a low revolution mixer (300-600 rpm) for 1-2 min. Stirring of the mixture should be performed thoroughly near the sides and bottom of the container in order to achieve uniform dispersion of the hardener. The resin component should be thoroughly stirred to incorporate any slight separation, whilst continuing stirring the contents of the hardener container should be added. Continue stirring until a homogeneous mix is obtained. The mixed material must be used within 20-30 minutes of mixing at 25°C.
- The polyurethane mixture is poured on the floor and spread using V - notched trowel 5.5 mm, with parallel use of special spiked-roller in order to release any possibly entrapped air and avoid the formation of bubbles.
- The next day, depending ambient temperature follows application of finishing paint **POLYSPORT 1052** in two layers.

---

## **CONSUMPTION**

2.0 - 2.2 Kg/m<sup>2</sup> for 1 layer

---

## **APPLICATION TOOLS**

V - Notched trowel 5.5 mm, spiked-roller. Tools should be cleaned with **PU SOLVENT** immediately after use.



---

## **PACKAGING**

Set of 280 kg (barrel and drum).



---

## **STORAGE**

12 months in unopened containers in dry places with minimum temperature 5°C and maximum temperature 30°C (avoid sunlight).

---

## **REMARKS**

- Substrate must be dry, clean, free from dust, grease and oil. Application must be done between 10°C and 40°C.
  - In case the layer of PU self-leveling is applied after more than 24 hours of the application of the last layer of PU pore filler then the whole surface must be sanded by a special sanding machine. After that the PU self-leveling can be applied.
- 

## **CAUTION**

The application must take place in well-aired places using protective gloves. Skin or eye contact must be avoided, otherwise wash carefully with soap and water.

**For more information consult the safety data sheet.**

---

The information given here is true, represents our best knowledge and is based not only on laboratory work, but also on field experience. However, because of numerous factors affecting results we offer this information without any guarantee and no patent liability is assumed. For additional information or questions, contact the technical department of KDF LTD.

# KDF-PU 1056 TOP COATING

## FOR SANDPROOF-WATERPOOF PLAYGROUND FLOORINGS

### GENERAL CHARACTERISTICS

**KDF-PU 1056 TOP COATING** is a polyurethane, two-component, solvent-based, glossy finish aliphatic, elastic coating for outdoor sports surfaces.

It is applied as a final, sealing layer on top of playground floorings made of **SBR rubber plus PU binder mixture**, or **EPDM plus PU binder mixture**, on safety tiles. Especially used as the sealing top coat in the **SAFEPOL SANDPROOF** system.

Provides a glossy surface with exceptional resistance in abrasion and various chemical agents.

It is UV-resistant and thus absolutely suitable for outdoor surfaces.

### TECHNICAL DATA

Mixing Ratio (transparent)	75 :25 (by weight)
Mixing Ratio (colored)	78 : 22 (by weight)
Density (25°C) (transparent)	0.9-1.0 kg/lt
Density (25°C) (colored)	1.08-1.18 kg/lt
Viscosity (25°C) (transparent)	50-400 mPa s at 25°C
Viscosity (25°C) (colored)	200-600 mPa s at 25°C
Application Temperature	10°C-40°C
Curing (25°C)	8-10 hour
Color	18 colors from KDF color chart

### PREPARATION-APPLICATION

- Good, dry cleaning of the surface from dust and residues using vacuum cleaner and squeegees.
- Caution must be taken so that temperature of the support surface as well as ambient air remains above 15°C during application and curing of the materials while relative humidity does not exceed 75%.
- The resin component should be thoroughly stirred to incorporate any slight separation, whilst continuing stirring the contents of the hardener container should be added. Continue stirring until a homogeneous mix is obtained. Airless sprayer or roller can apply **KDF-PU 1056 TOP COATING**.

### CONSUMPTION

App.350-400 gr/m<sup>2</sup> for the SAFEPOL SANDPROOF system. Apply three coats at least.

### PACKAGING

5kg, 15kg set (A+B).



### APPLICATION TOOLS

Airless sprayer or roller.



---

## **STORAGE**

12 months in unopened containers in dry places with minimum temperature 5°C and maximum temperature 30°C.

---

## **REMARKS**

- Working time of **KDF-PU 1056 TOP COATING** decreases when ambient temperature rises.
  - Prolonged storage of partially used containers containing **KDF-PU 1056 TOP COATING** must be avoided as contact with atmospheric moisture will result in skinning and clouding of the product.
  - After hardening **KDF-PU 1056 TOP COATING** is completely safe for health.
  - The three layers of **KDF-PU 1056 TOP COATING** will have to be applied strictly within 24 hours of one another (European conditions) **or within 3-6 hours (GCC high-temperature conditions)** in order to cover the surface swiftly and protect it from unwanted weather or other adverse conditions (sand dust, accumulated dirt or foreign matter etc.). In case the 24-hour limit (Europe) or the 3-6-hour limit (GCC) is surpassed or weather or other adverse conditions interfere between layers at any time, the surface might need sanding again to restore smoothness and cleanliness before applying subsequent layers of the aliphatic top coat.
- 

## **CAUTION**

The application must take place in well-aired places using protective gloves. Skin or eye contact must be avoided, otherwise wash carefully with soap and water.

**For more information consult the material safety data sheet.**

---

The information given here is true, represents our best knowledge and is based not only on laboratory work, but also on field experience. However, because of numerous factors affecting results we offer this information without any guarantee and no patent liability is assumed. For additional information or questions, contact the technical department of KDF LTD.

# CLEANING AND MAINTENANCE MANUAL FOR :

## -OUTDOOR SPORTS FLOORING

## -PLAYGROUND FLOORINGS

### Introduction

Outdoor sports floorings and playground surfaces are made of extremely durable polymers, designed to withstand extreme climate conditions and intense use. However for the best maintenance of the sports surface a regular check (once in 6 months) is required and the maintenance of the surface is necessary to preserve the suitability and functionality of the flooring.

The installer's guarantee will usually be conditional on the recommended maintenance requirements being carried out with due diligence.

### Maintenance

Maintenance procedures are necessary to preserve the lifetime of the surface and to ensure that:

- The Surface is kept clean.
- The Surface is safe for intense and diverse use.

These objectives are achieved by :

- Sweeping/removing leaves and other debris from the surface.
- Regularly washing the surface with a soft brush to remove contaminants such as grime, grease, algae, moss, sand etc.
- Applying suitable treatments of moss-killer and/or algaecide
- Periodically removing weed growth from the perimeter kerb lines.

### Maintenance Equipment

- Leaves, pine needles and other detritus should be removed from the surface immediately as rot quickly helping the growth of mold and moss.
- A mechanical leaf-sweeper or vacuum cleaner is ideal for removing vegetable matter and dirt. Restricted areas may have to be cleaned by hand.
- The maintenance equipment should be well maintained and carefully operated to avoid any physical damage to the surface.
- Pressure loads on the surface as well as friction and shearing loads have to be avoided to prevent damage to the surface.
- At least once a year it is advisable to wash the surface with **low-pressure** jetting apparatus.

- Polymeric surfaces can withstand low pressures without suffering damage.
- Note that no aggressive chemical cleaning agents (chlorine or acid-based) should be used.

### **Prevention of damages**

To ensure the excellent condition of the surface:

- It is forbidden to drive vehicles, bicycles or motorcycles on the surface.
- Chemicals, oils, fuels or solvents on the surface are prohibited.
- Fireworks or cigarettes or unsuitable shoes on the surface are prohibited.

### **Damages and renovation**

The lifetime of an outdoor sports/playground surface depends on its quality, usage and level of maintenance. In general a normal outdoor sports/playground surface used intensively will last 7 to 12 years (depending on the system) before renovation is required. Renovation should be carried out periodically to prevent the total damage of the surface, which would necessitate complete renewal.

Renovation must be carried out by professional and skilled contractors with thorough knowledge of this type of work.

There are different procedures for the renovation of a surface:

- Complete renewal by replacing the worn-out surface with a new sports flooring system.
- Re-topping or sealing with adequate polyurethane or acrylic materials.
- Partial re-topping in particular worn-out areas.

Information contained in this document is of general nature and is given in good faith. As the state of the surface and the use and application of the various cleaning products, is out of our control, our advice for individual cases, verbal, written or based on tests, does not exempt the applicator from the testing the suitability of the cleaning products and their applications.

The above maintenance guide refers to **the below KDF systems:**

**-SYSTEM SPORTFLOOR FAST**

**-SYSTEM SPORTFLOOR-EX**

**-SYSTEM SPORTFLOOR-EX-R**

**-SYSTEM FLEXFLOOR-EX**

**-SYSTEM FLEXFLOOR-EX-R**

**-SYSTEM POLYFLEX AEL -EX**

- SYSTEM POLYFLEX AEL -EX-R**
- SYSTEM POLYFLEX WET -POUR EX**
- SYSTEM POLYFLEX WET -POUR EX-R**
- SYSTEM POLYFLEX PU -EX**
- SYSTEM POLYFLEX WET -POUR AEL-EX**
- SYSTEM POLYFLEX WET -POUR AEL-EX-R**
- SYSTEM SMARTFLOOR-EX**
- SYSTEM SAFEPOL MULTICOLOR**
- SYSTEM SAFEPOL COLORED**
- SYSTEM SAFEPOL WITH TPV GRANULES**
- SYSTEM SAFEPOL SBR COLOURANT**
- SYSTEM SAFEPOL SANDPROOF**
- SYSTEM QUICKLAWN PLAYGROUND SAFEPOL**
- SYSTEM QUICKLAWN PLAYGROUND SAFEPOLSANDPROOF**
- SYSTEM COLORFLEX**
- SYSTEM SPORTGROUND-EX**
- SYSTEM DECOQUARTZ**
- SYSTEM POLTRACK SPRAYCOAT**
- SYSTEM POLTRACK SPRAYCOAT SEALED**
- SYSTEM POLTRACK SANDWICH**
- SYSTEM POLTRACK ROLL-SANDWICH**
- SYSTEM POLTRACK FULL PU**
- SYSTEM POLTRACK ACRYLIC**
- SYSTEM POLTRACK JOGGING TRACK**
- SYSTEM POLTRACK PU JOGGING TRACK**
- SYSTEM POLTRACK JOGGING TRACK SBR**
- SYSTEM POLTRACK JOGGING TRACK SHOCK-PAD - EPDM**
- SYSTEM POLTRACK JOGGING TRACK SHOCK-PAD - ISOPOL**
- SYSTEM POLTRACK EQUINE**